



## KJP TYPE

### 주요용도(Application)

공작기계, 목공기계, 섬유기계, 취출로봇, 자동화기계, 운반기계, 컴퓨터 관련기기 등에 적용됩니다.

Application for Wood work machine, Fabric machine, Grabbing-and-extracting robot, Factory automation, Machining center and Computer related machine.

### 특징(Features)

KJP Type은 플라스틱 Cable Chain으로 개폐형으로 설계되어 Cable, Hose의 설치가 용이하며 소음이 적고 가벼워서 움직임이 많고 속도가 빠른 단거리에 적합한 제품입니다.

- KJP Type provides cover lead for easy installation of cable and hose.
- Since it is light, movement is prompt.
- All parts are made of highly durable engineering plastic.
- It features less noise, good appearance and light weight.

## ⊕ 체인 길이 계산법

$$L = \frac{Ls}{2} + \pi R + 3P$$

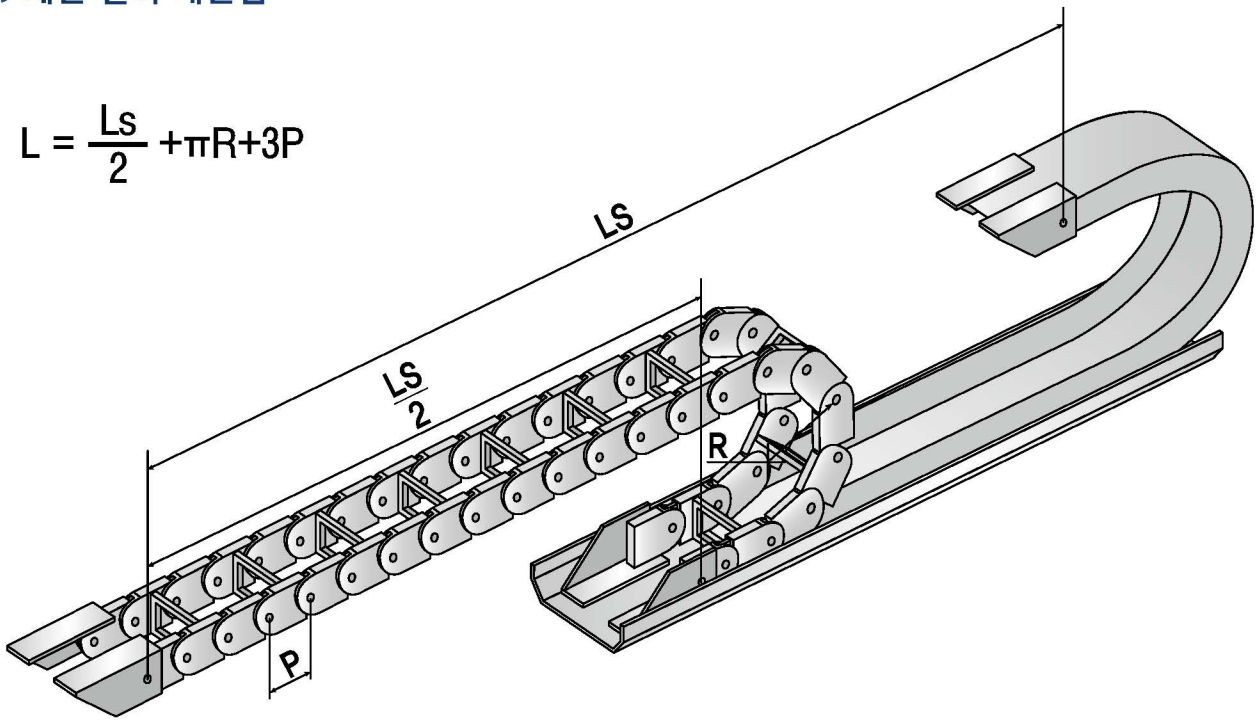

## KJP Type 구조

- |                    |                    |
|--------------------|--------------------|
| KJP 0130 - 1B TYPE | KJP 0350 - 1B TYPE |
| KJP 0130 - 2B TYPE | KJP 0350 - 2B TYPE |
| KJP 0130 - 4B TYPE | KJP 0450 - 1B TYPE |
| KJP 0150 - 1B TYPE | KJP 0450 - 2B TYPE |
| KJP 0180 - 1B TYPE | KJP 0450 - 3B TYPE |
| KJP 0180 - 2B TYPE | KJP 0450 - 4B TYPE |
| KJP 0180 - 4B TYPE | KJP 0625 - 1B TYPE |
| KJP 0320 - 1B TYPE | KJP 0625 - 2B TYPE |
| KJP 0320 - 2B TYPE | KJP 0625 - 3B TYPE |
| KJP 0320 - 3B TYPE |                    |

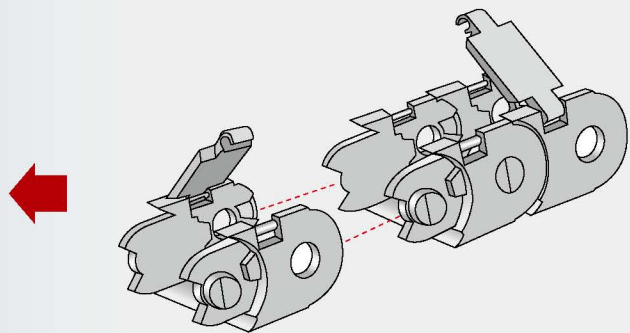

## ⊕ 능력선도

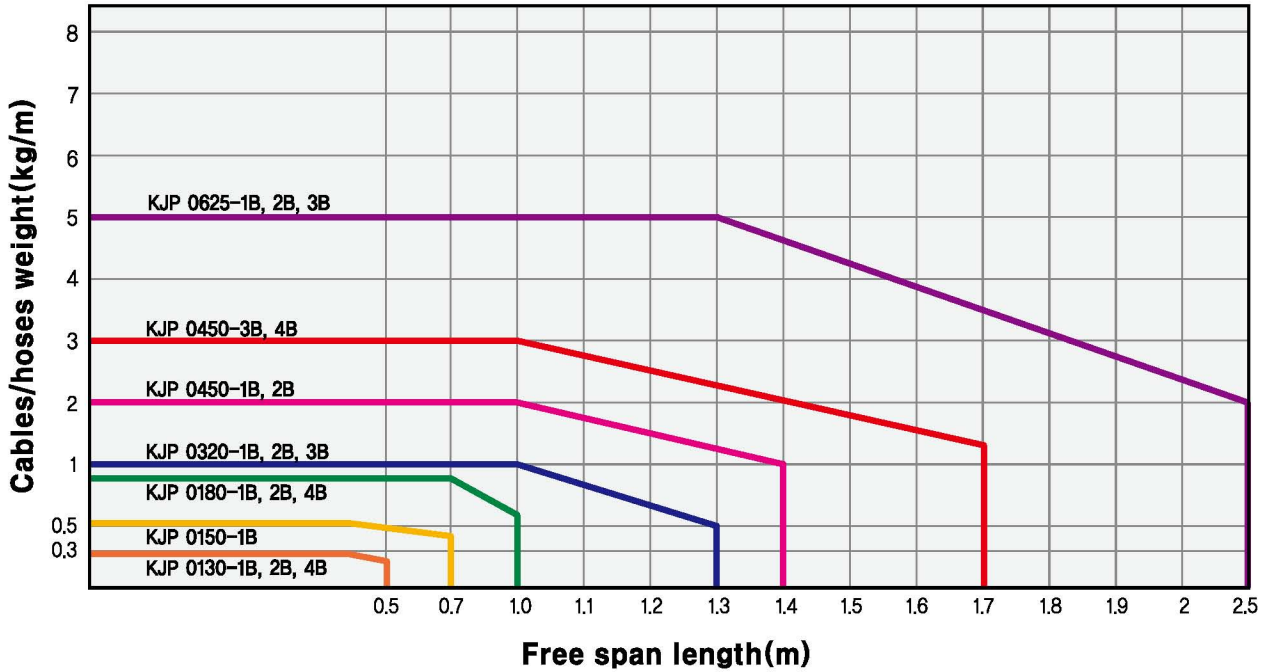

## ⊕ Dimension

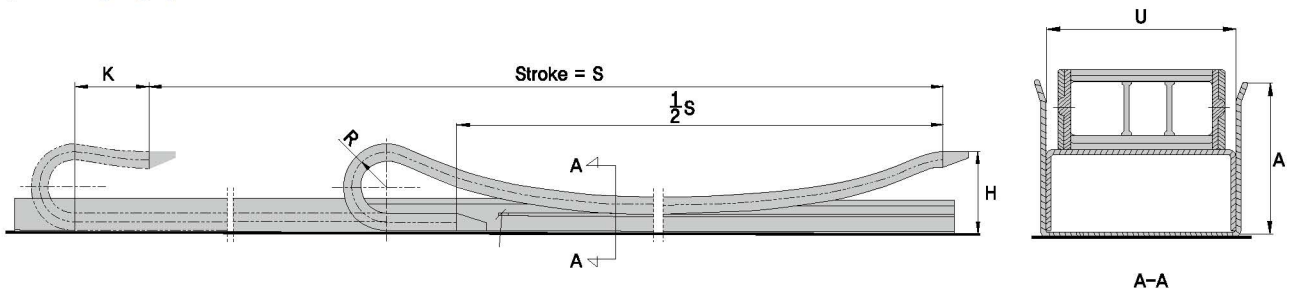

Type	S(stroke)	Max, Supporter Weight	H	U	A	K
KJP 0320-1B	20m	0.5kg/m	100	35	60	120이상
0320-2B	20m	1kg/m	100	48	60	120이상
0320-3B	20m	1kg/m	100	74	60	120이상
0450-1B	20m	1kg/m	140	70	90	200이상
0450-2B	20m	1.5kg/m	140	90	90	200이상
0450-3B	20m	1.5kg/m	140	110	90	200이상
0450-4B	20m	2kg/m	140	130	90	200이상
0625-1B	30m	3kg/m	210	103	140	300이상
0625-2B	30m	3kg/m	210	141	140	300이상
0625-3B	30m	3.5kg/m	210	183	140	300이상

KJP TYPE

# KJP 0130-1B

KUKJE CABLECHAIN

## ⊕ Cablechain / Chain Pitch(P)=13mm

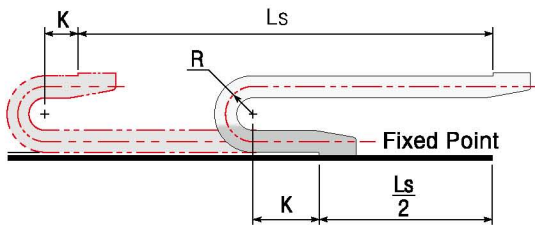
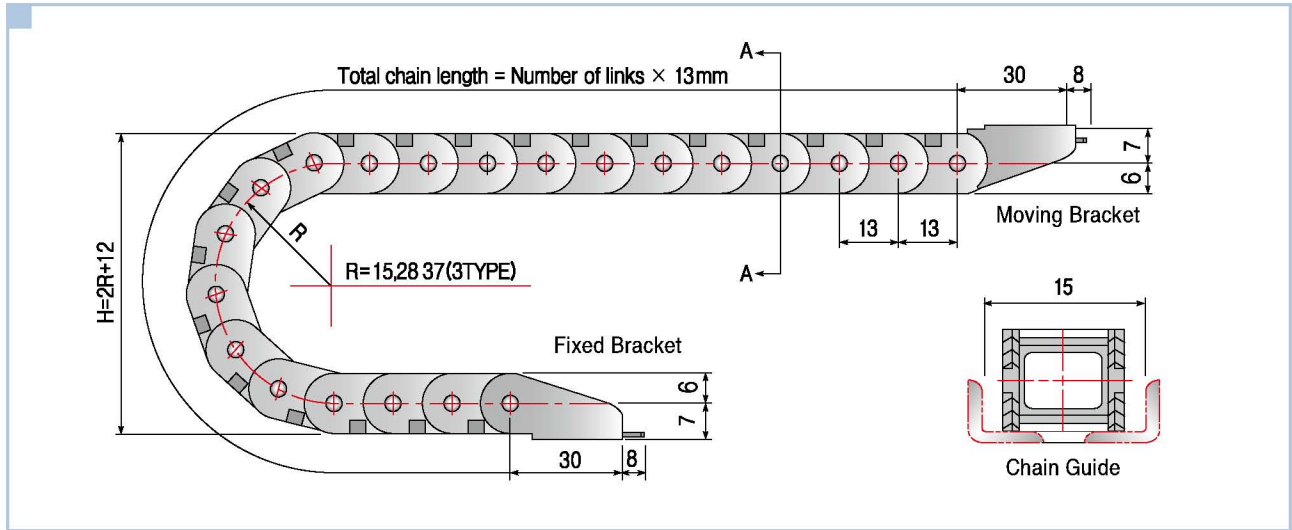

- Chain Length  $L = \frac{Ls}{2} + \pi R + 3P(2K)$
- 곡률반경에 따른 H값

R	15	28	37
H	42	68	86

## ⊕ A-A Cross Section / D.Max

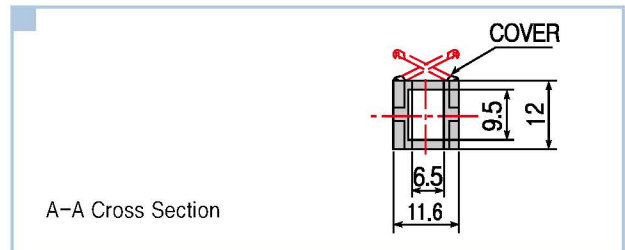
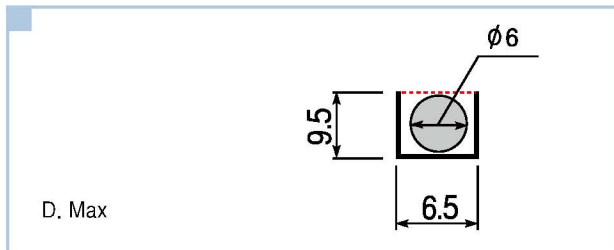

## ⊕ End Bracket

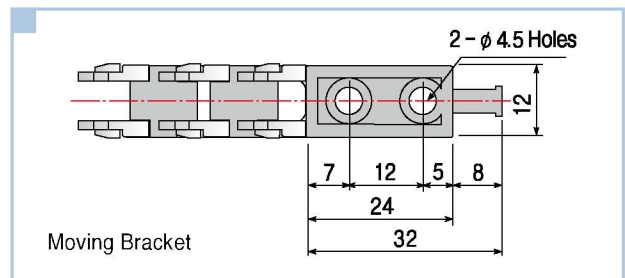
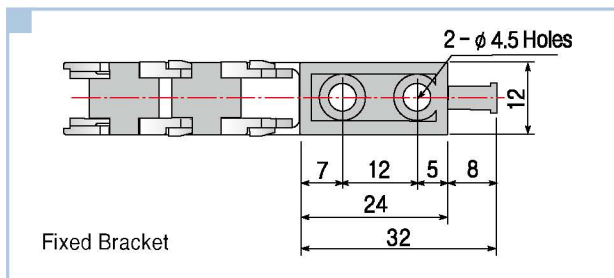

## ⊕ Order Example [ 주문예 ]

KJP 0130-1B / Type ➤ R15 / Radius ➤ 450L / Length ➤ 20Sets / Q'ty

⊕ Cablechain / Chain Pitch(P)=13mm

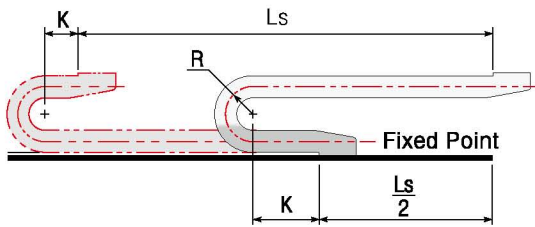
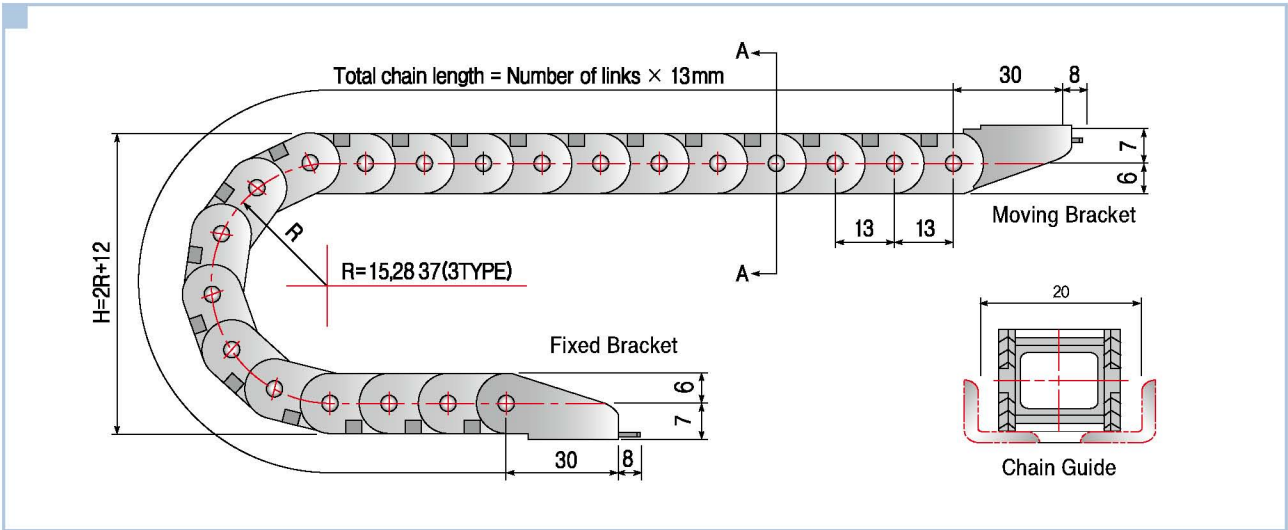

- Chain Length  $L = \frac{Ls}{2} + \pi R + 3P(2K)$
- 곡률반경에 따른 H값

R	15	28	37
H	42	68	86

⊕ A-A Cross Section / D.Max

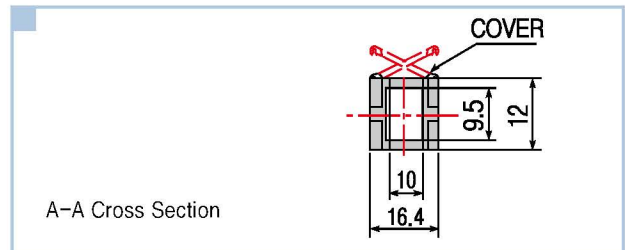
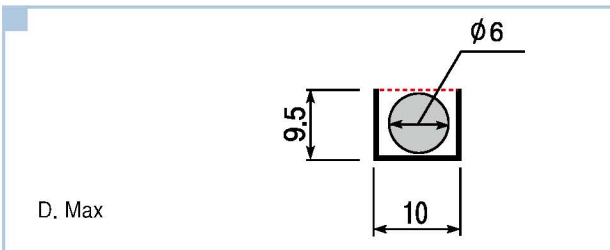

⊕ End Bracket

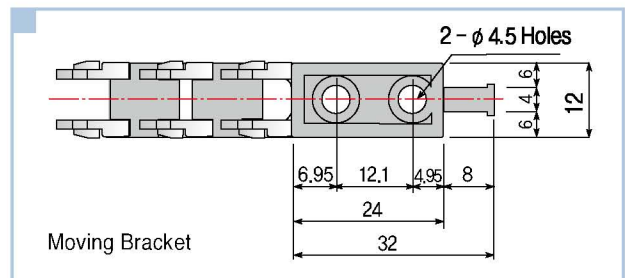
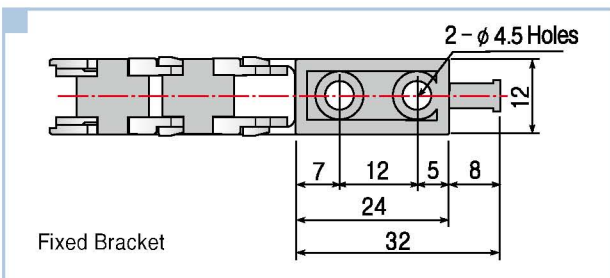

⊕ Order Example [ 주문예 ]

KJP 0130-2B / Type ➤ R15 / Radius ➤ 450L / Length ➤ 20Sets / Q'ty

# KJP 0130-4B

KUKJE CABLECHAIN

KJP TYPE

## ⊕ Cablechain / Chain Pitch(P)=13mm

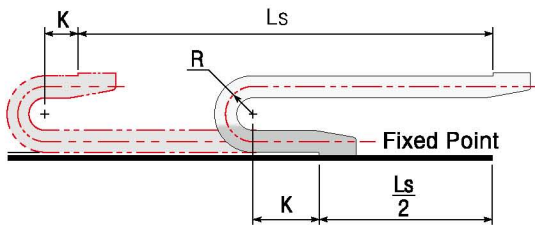
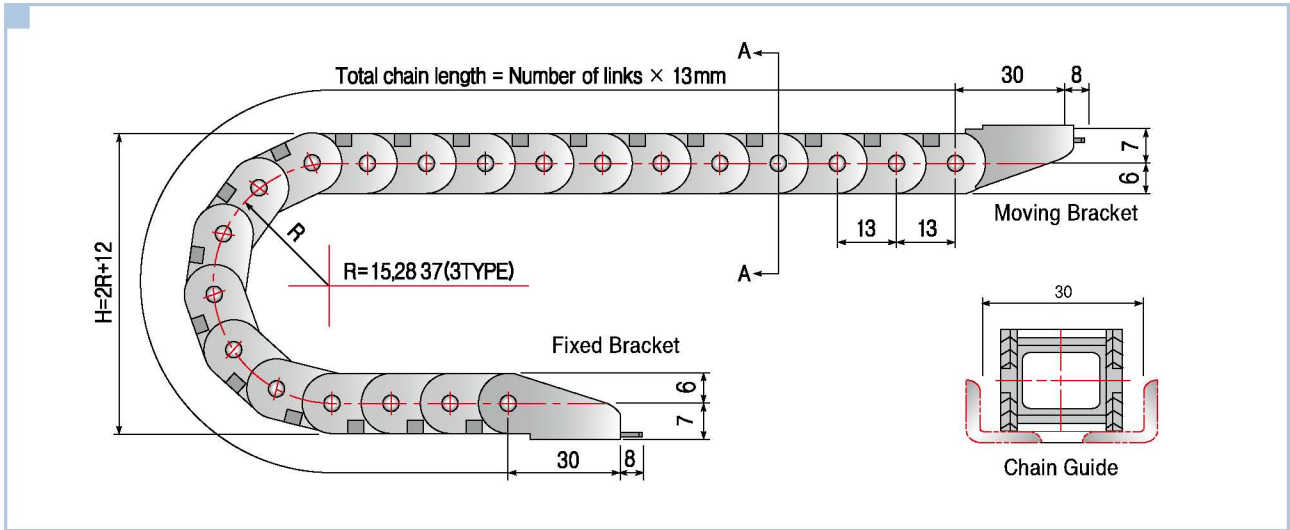

- Chain Length  $L = \frac{Ls}{2} + \pi R + 3P(2K)$
- 곡률반경에 따른 H값

R	15	28	37
H	42	68	86

## ⊕ A-A Cross Section / D.Max

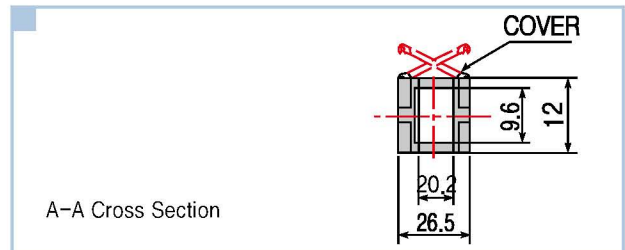
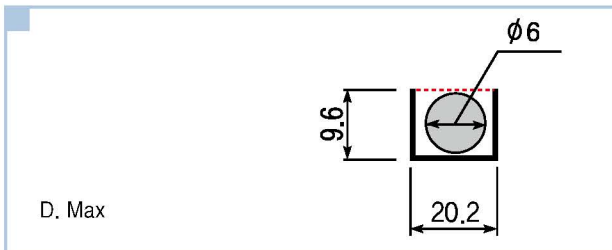

## ⊕ End Bracket

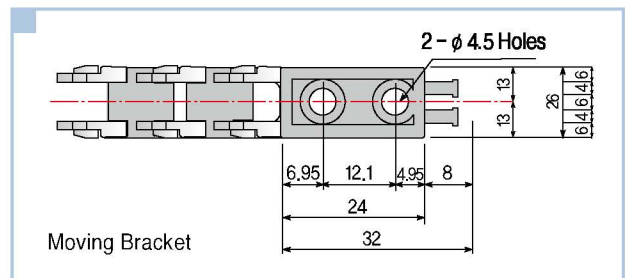
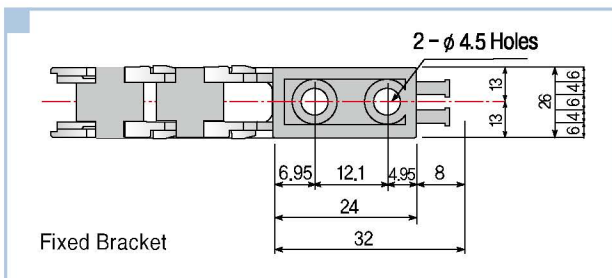

## ⊕ Order Example [ 주문예 ]

KJP 0130-4B / Type ➤ R15 / Radius ➤ 450L / Length ➤ 20Sets / Q'ty

⊕ Cablechain / Chain Pitch(P)=15mm

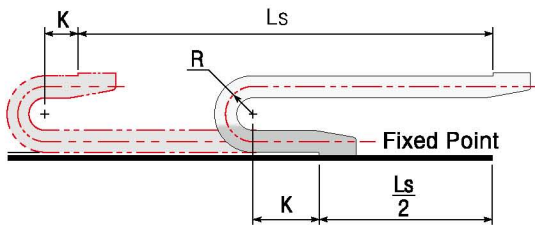
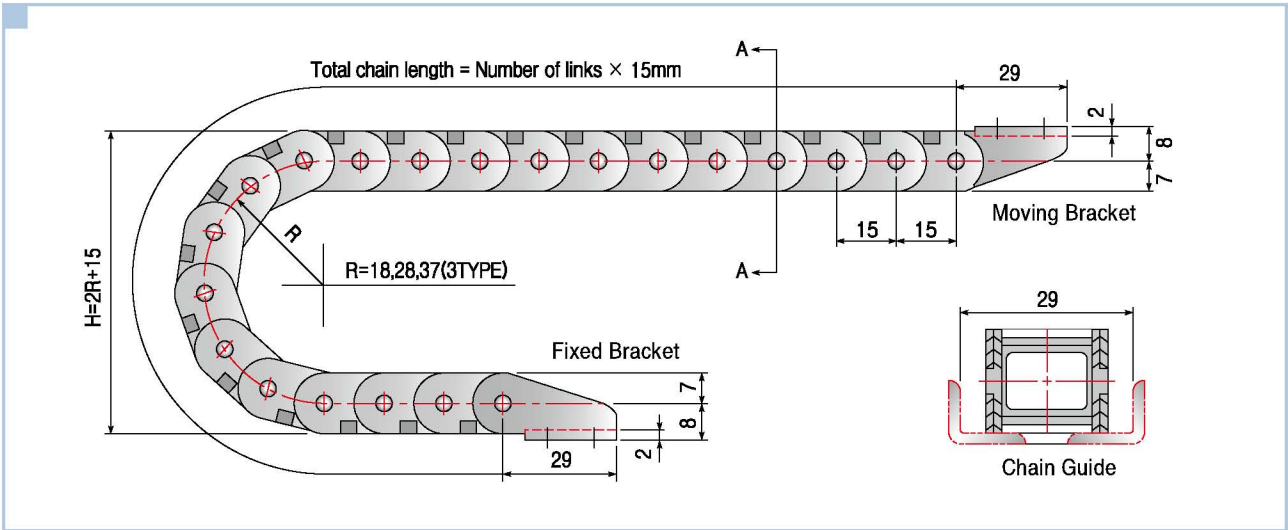

- Chain Length  $L = \frac{Ls}{2} + \pi R + 3P(2K)$
- 곡률반경에 따른 H값

R	18	28	37
H	51	71	89

⊕ A-A Cross Section / D.Max

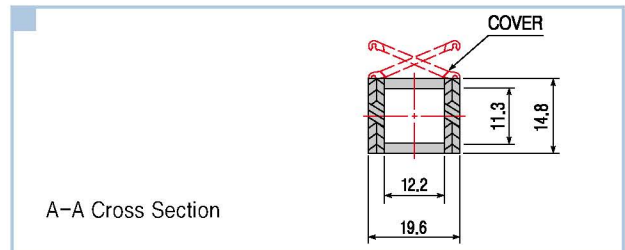
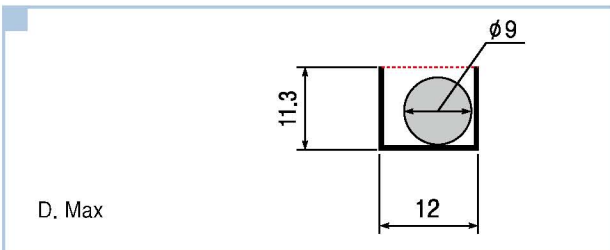

⊕ End Bracket

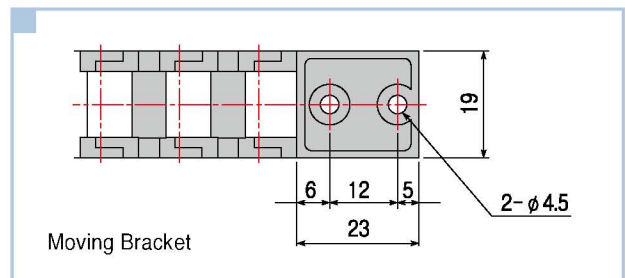
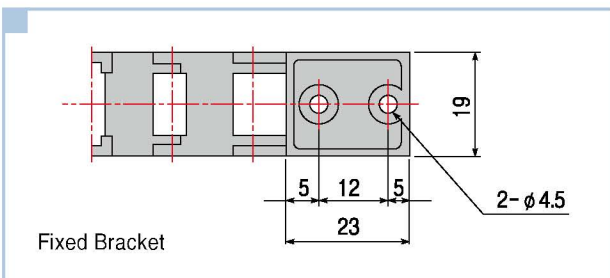

⊕ Order Example [ 주문예 ]

KJP 0150-1B / Type ➤ R18 / Radius ➤ 450L / Length ➤ 20Sets / Q'ty

KJP TYPE

# KJP 0180-1B

KUKJE CABLECHAIN

## ⊕ Cablechain / Chain Pitch(P)=18mm

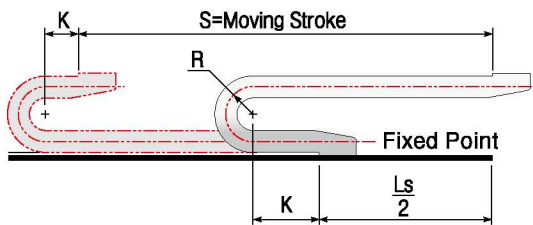
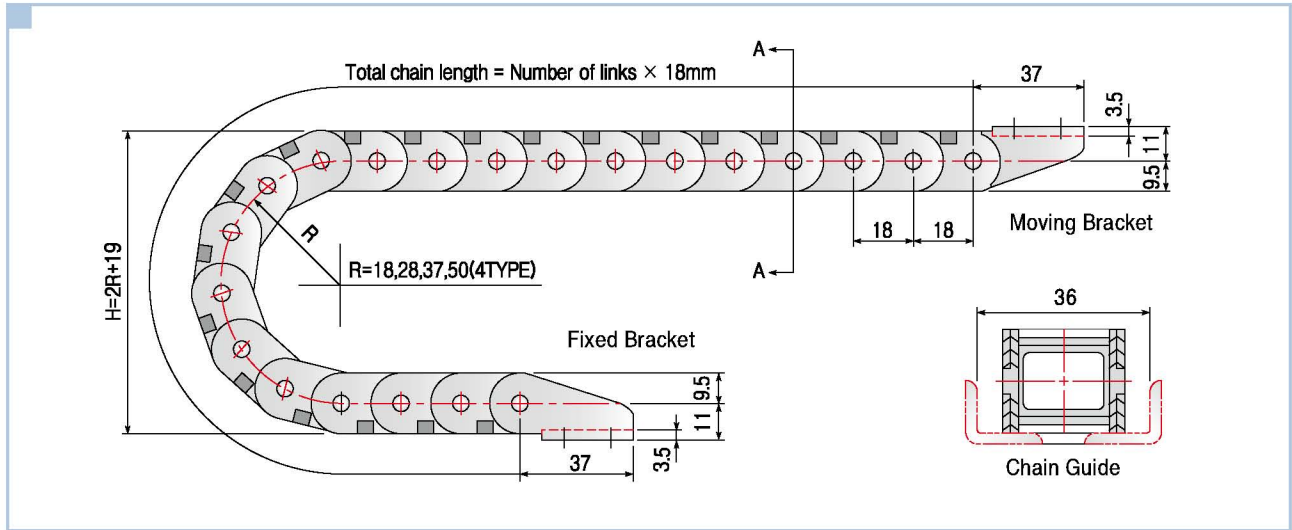

- Chain Length  $L = \frac{Ls}{2} + \pi R + 3P(2K)$
- 곡률반경에 따른 H값

R	18	28	37	50
H	55	75	93	119

## ⊕ A-A Cross Section / D.Max

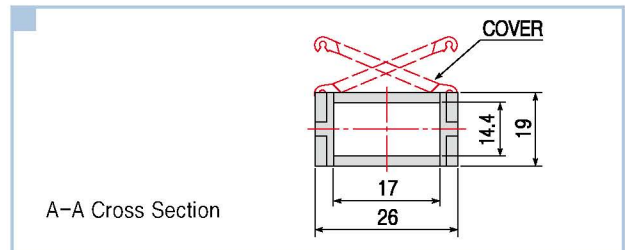
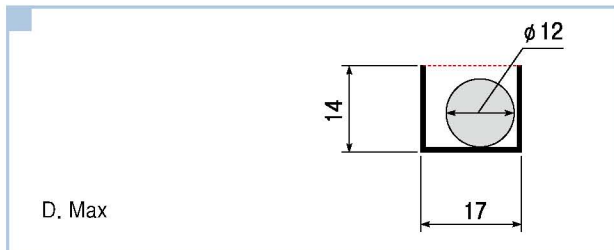

## ⊕ End Bracket

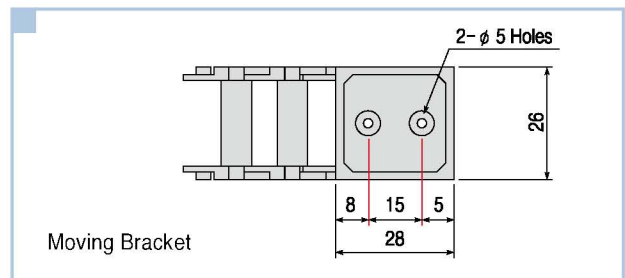
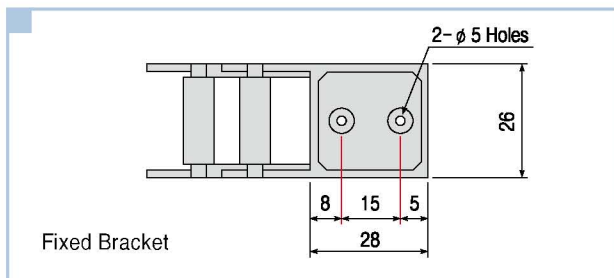

## ⊕ Order Example [ 주문예 ]

KJP 0180-1B / Type ➤ R50 / Radius ➤ 1000L / Length ➤ 3Sets / Q'ty



⊕ Cablechain / Chain Pitch(P)=18mm

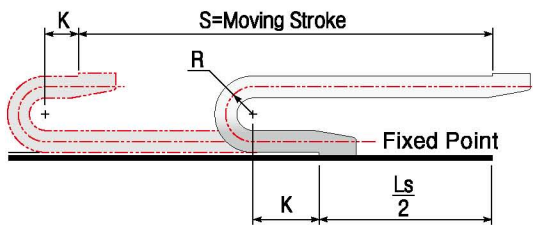
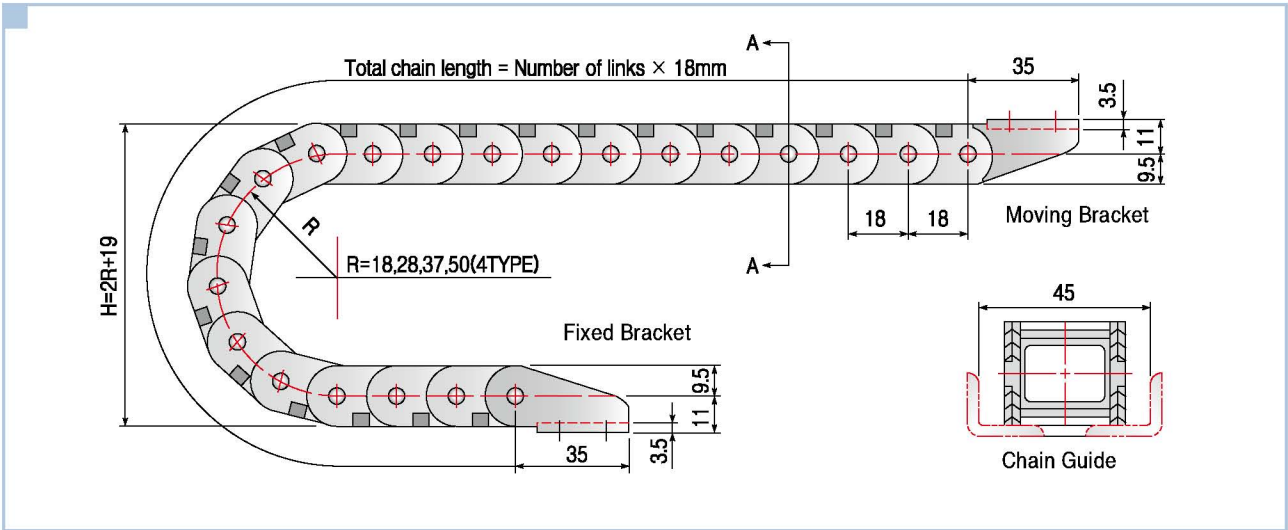

- Chain Length  $L = \frac{Ls}{2} + \pi R + 3P(2K)$
- 곡률반경에 따른 H값

R	18	28	37	50
H	55	75	93	119

⊕ A-A Cross Section / D.Max

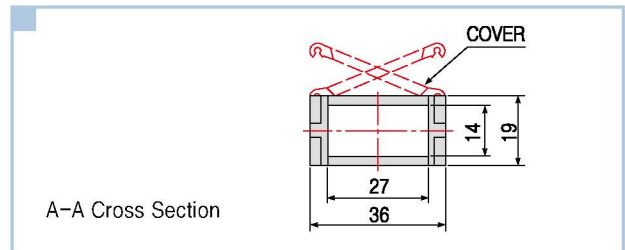
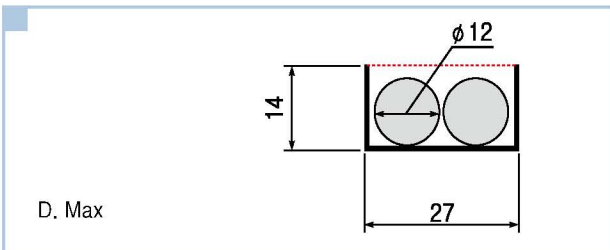

⊕ End Bracket

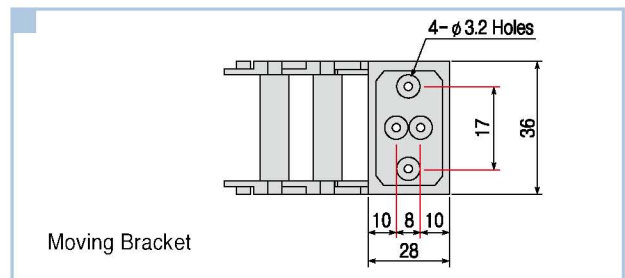
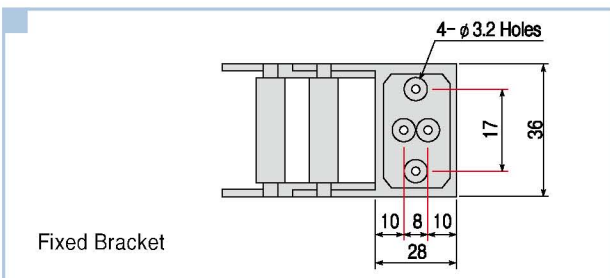

⊕ Order Example [ 주문예 ]

KJP 0180-2B / Type ➤ R50 / Radius ➤ 1000L / Length ➤ 3Sets / Q'ty

KJP TYPE

# KJP 0180-4B

KUKJE CABLECHAIN

## ⊕ Cablechain / Chain Pitch(P)=18mm

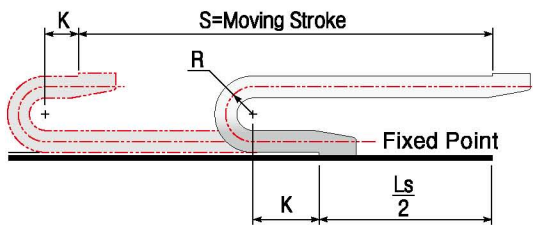
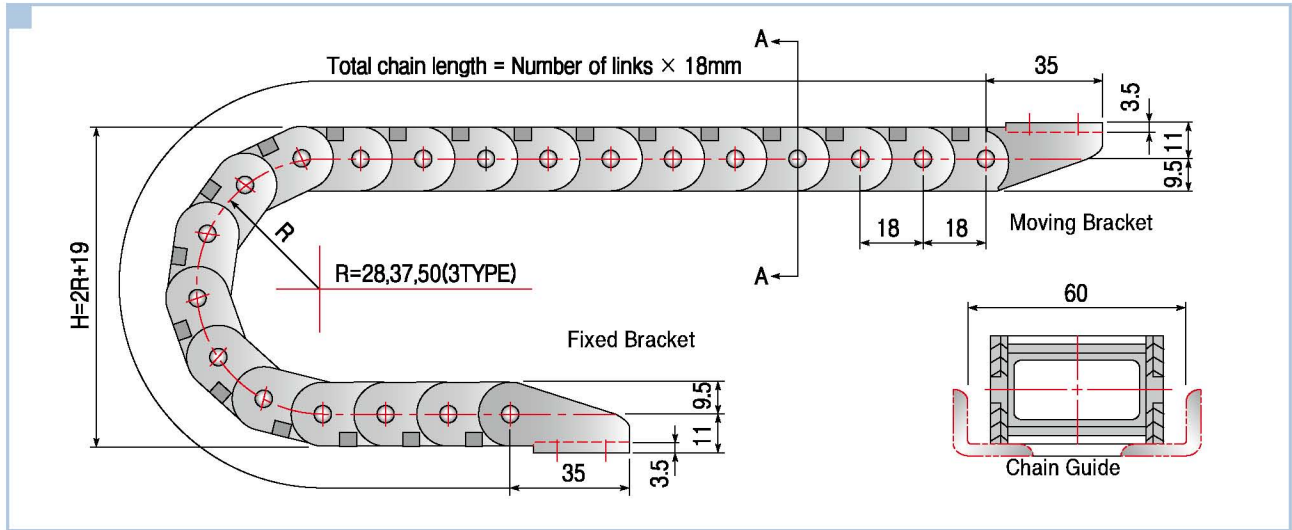

- Chain Length  $L = \frac{Ls}{2} + \pi R + 3P(2K)$
- 곡률반경에 따른 H값

R	28	37	50
H	75	93	119

## ⊕ A-A Cross Section / D.Max

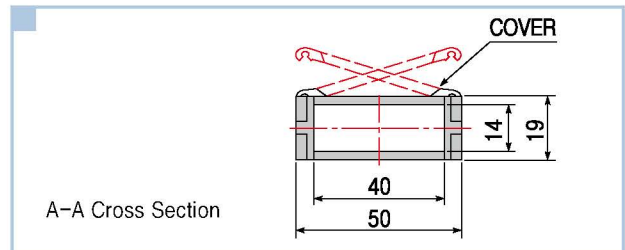
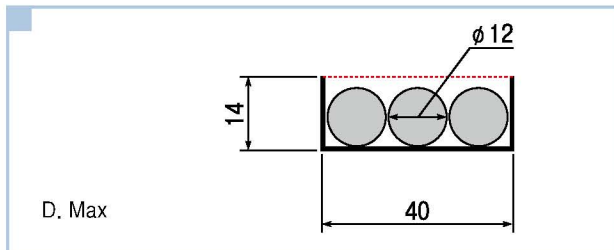

## ⊕ End Bracket

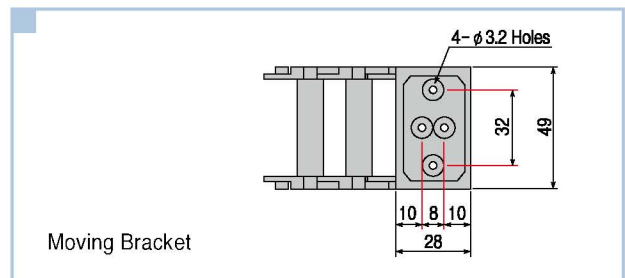
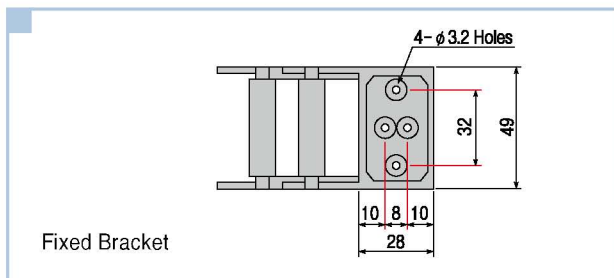

## ⊕ Order Example [ 주문예 ]

KJP 0180-4B / Type ➤ R50 / Radius ➤ 1000L / Length ➤ 3Sets / Q'ty

## ⊕ Cablechain / Chain Pitch(P)=32mm

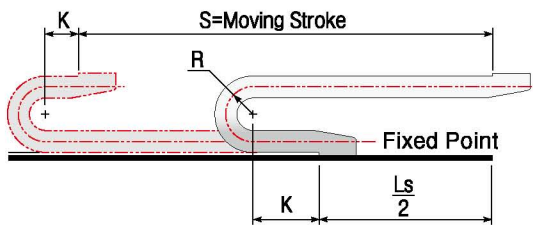
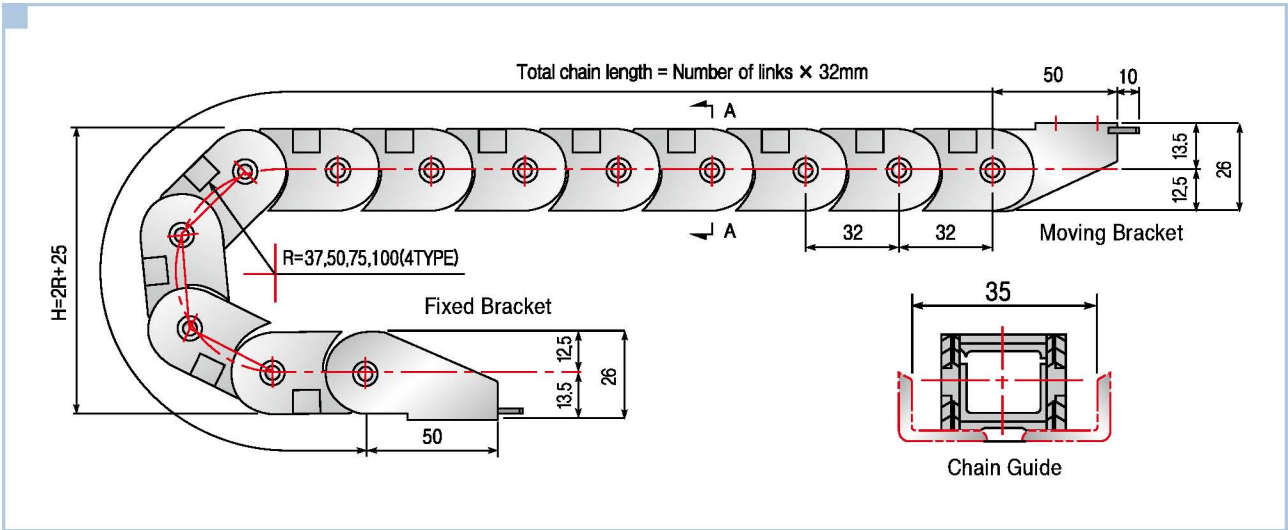

- Chain Length  $L = \frac{Ls}{2} + \pi R + 3P(2K)$
- 곡률반경에 따른 H값

R	37	50	75	100
H	99	125	175	225

## ⊕ A-A Cross Section / D.Max

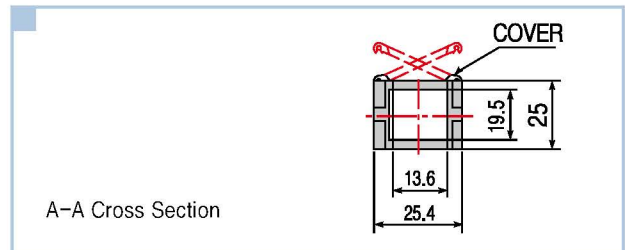
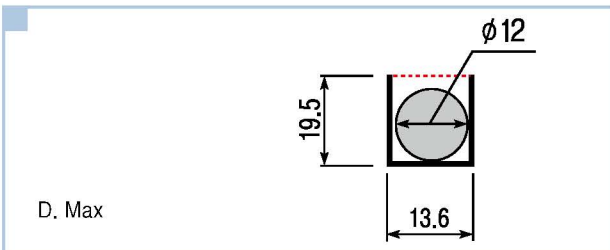

## ⊕ End Bracket

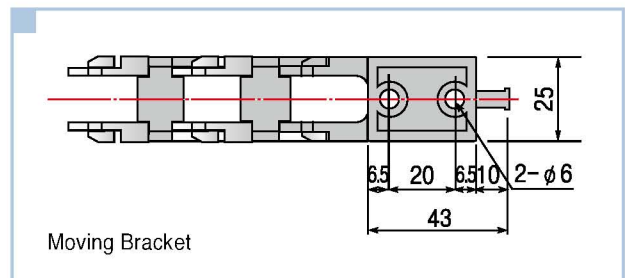
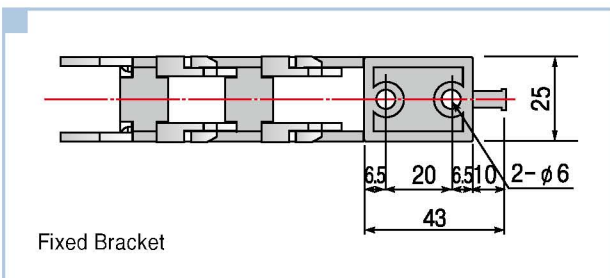

## ⊕ Order Example [ 주문예 ]

KJP 0320-1B / Type ➤ R50 / Radius ➤ 1000L / Length ➤ 3Sets / Q'ty

# KJP 0320-2B

KUKJE CABLECHAIN

## Cablechain / Chain Pitch(P)=32mm

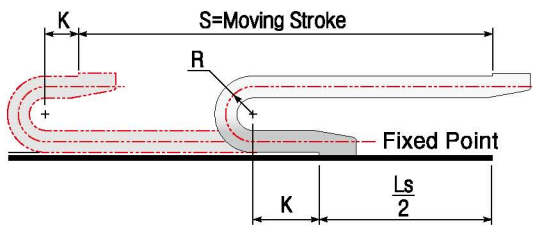
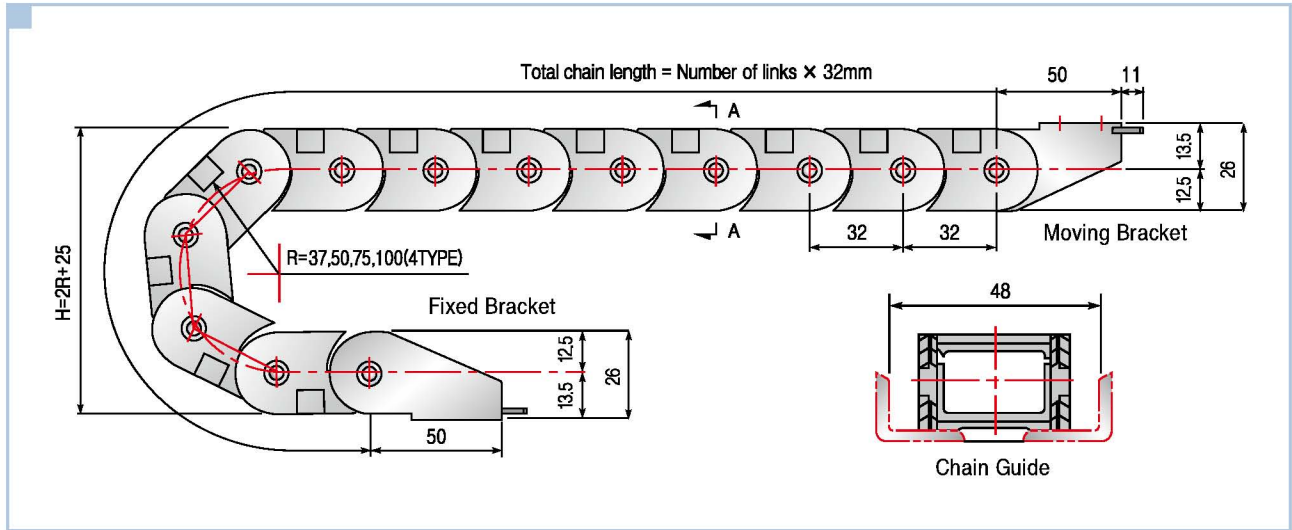

- Chain Length  $L = \frac{Ls}{2} + \pi R + 3P(2K)$
- 곡률반경에 따른 H값

R	37	50	75	100
H	99	125	175	225

## A-A Cross Section / D.Max

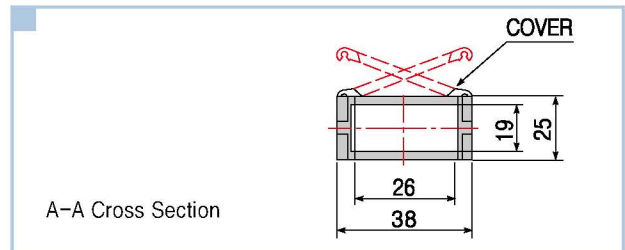
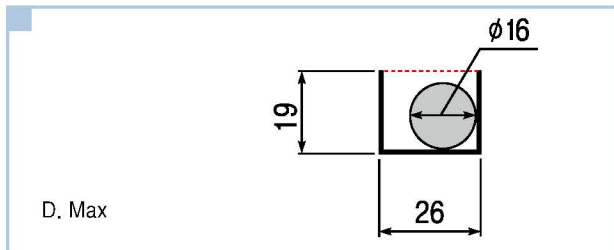

## End Bracket

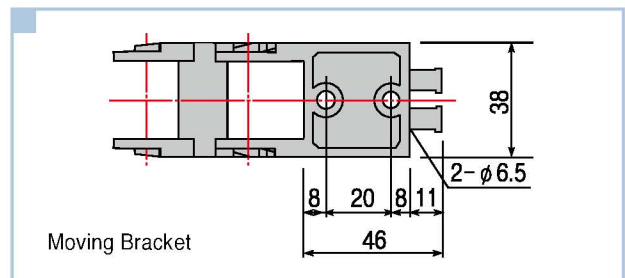
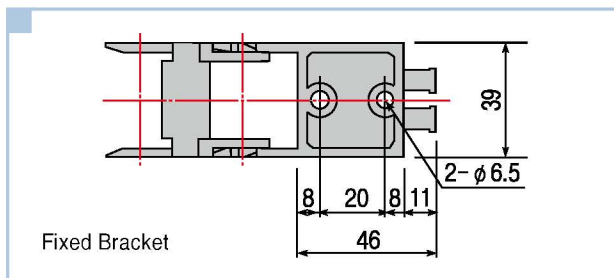

## Order Example [ 주문예 ]

KJP 0320-2B / Type ➤ R50 / Radius ➤ 1000L / Length ➤ 3Sets / Q'ty

⊕ Cablechain / Chain Pitch(P)=32mm

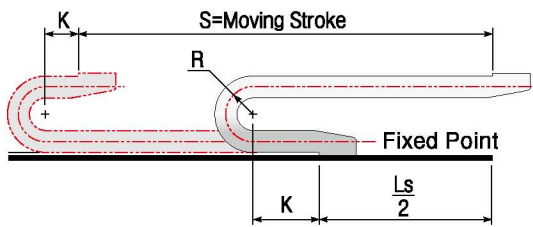
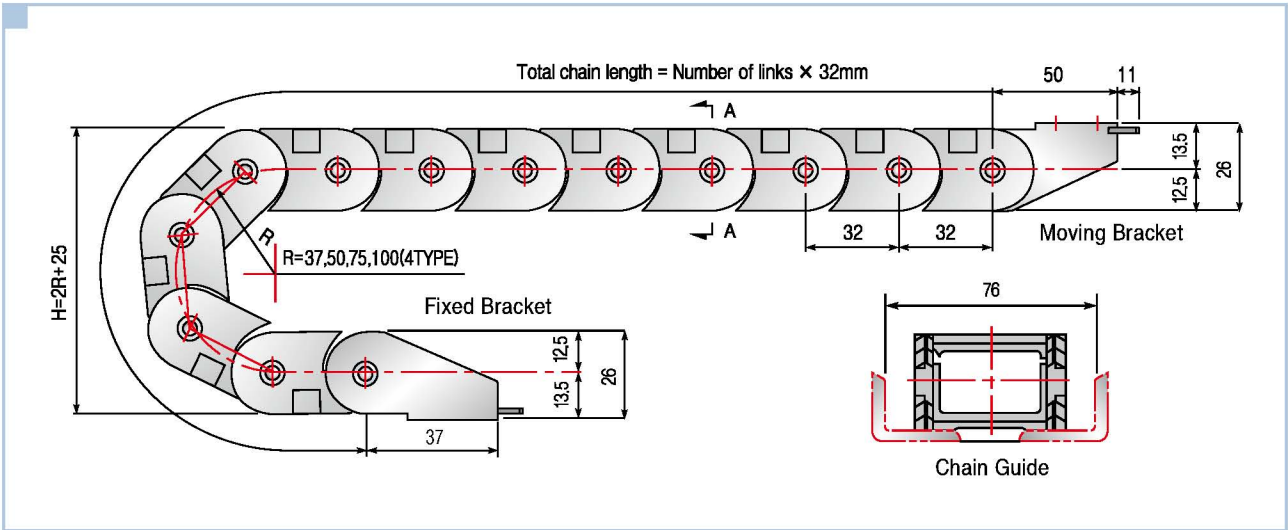

- Chain Length  $L = \frac{Ls}{2} + \pi R + 3P(2K)$
- 곡률반경에 따른 H값

R	37	50	75	100
H	99	125	175	225

⊕ A-A Cross Section / D.Max

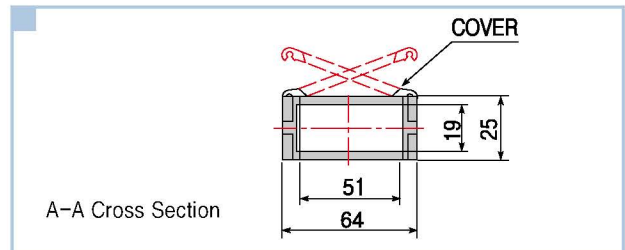
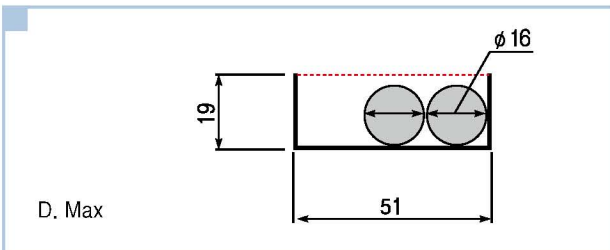

⊕ End Bracket

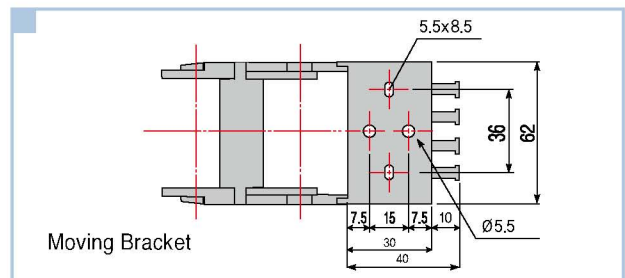
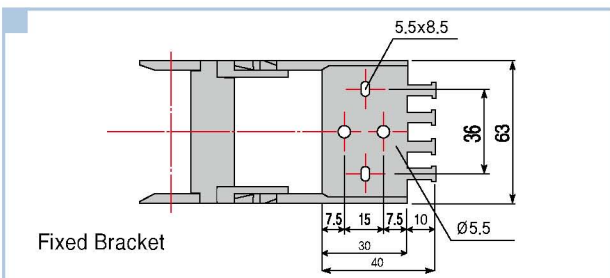

⊕ Order Example [ 주문예 ]

KJP 0320-3B / Type ➤ R37 / Radius ➤ 864L / Length ➤ 100Sets / Q'ty

KJP TYPE

# KJP 0350-1B

KUKJE CABLECHAIN

## ⊕ Cablechain / Chain Pitch(P)=35mm

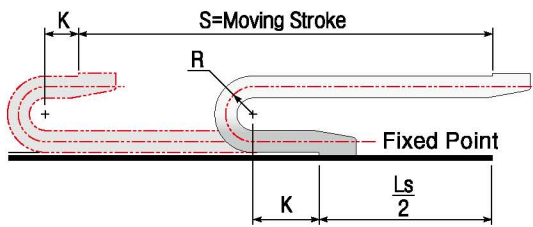
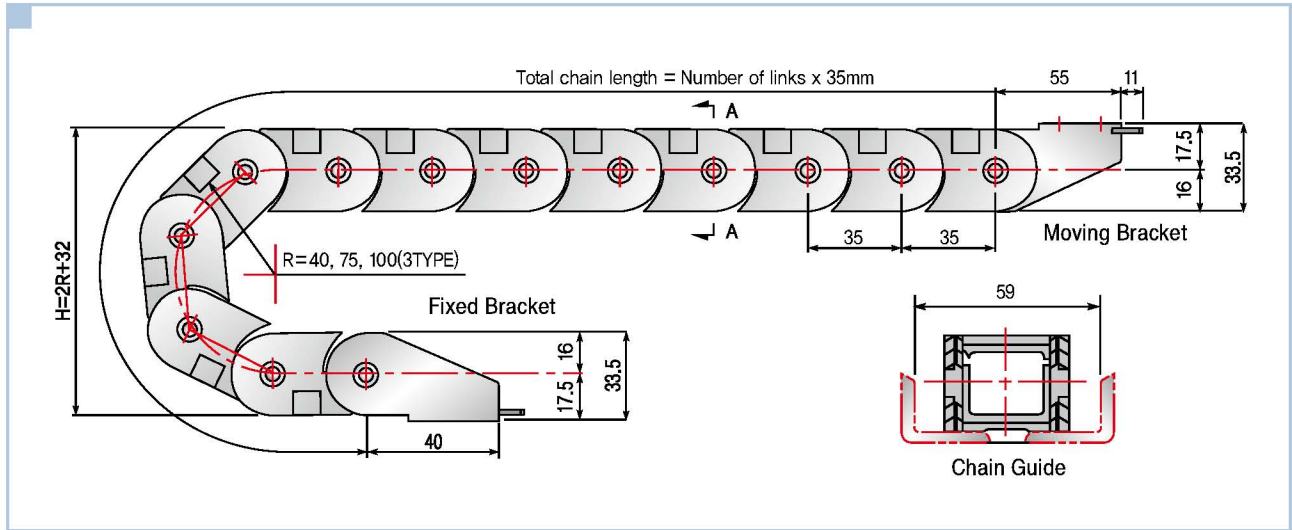

- Chain Length  $L = \frac{Ls}{2} + \pi R + 3P(2K)$
- 곡률반경에 따른 H값

R	40	75	100
H	112	182	232

## ⊕ A-A Cross Section / D.Max

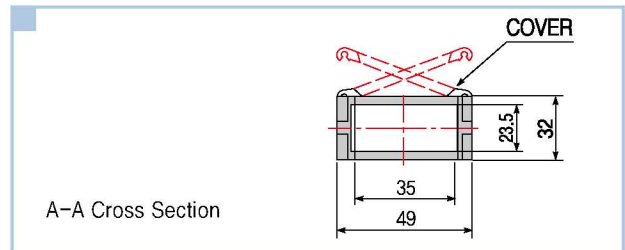
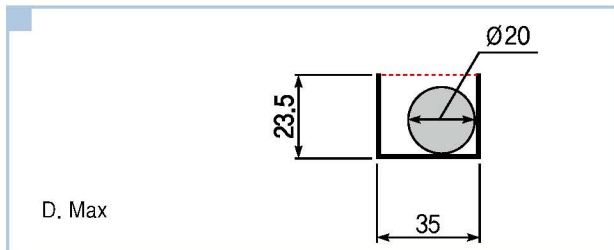

## ⊕ End Bracket

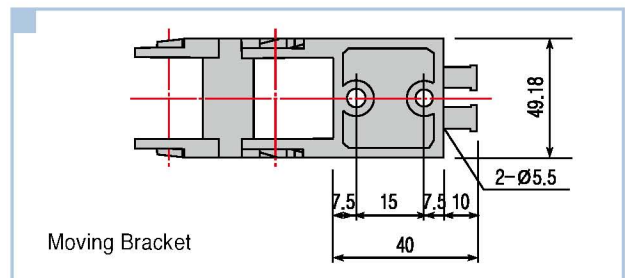
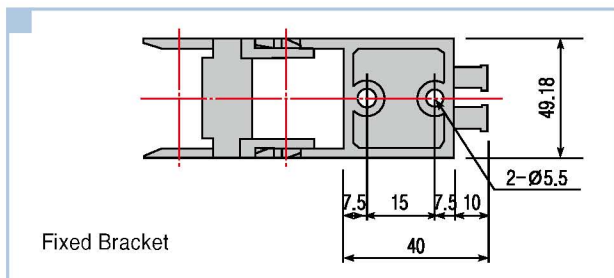

## ⊕ Order Example [ 주문예 ]

KJP 0350-1B / Type ➤ R40 / Radius ➤ 1000L / Length ➤ 3Sets / Q'ty

⊕ Cablechain / Chain Pitch(P)=35mm

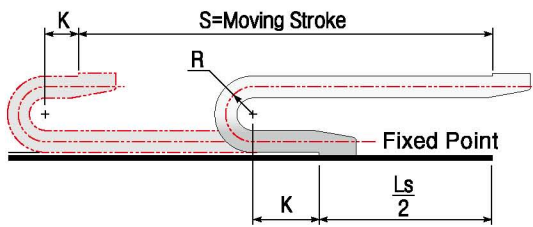
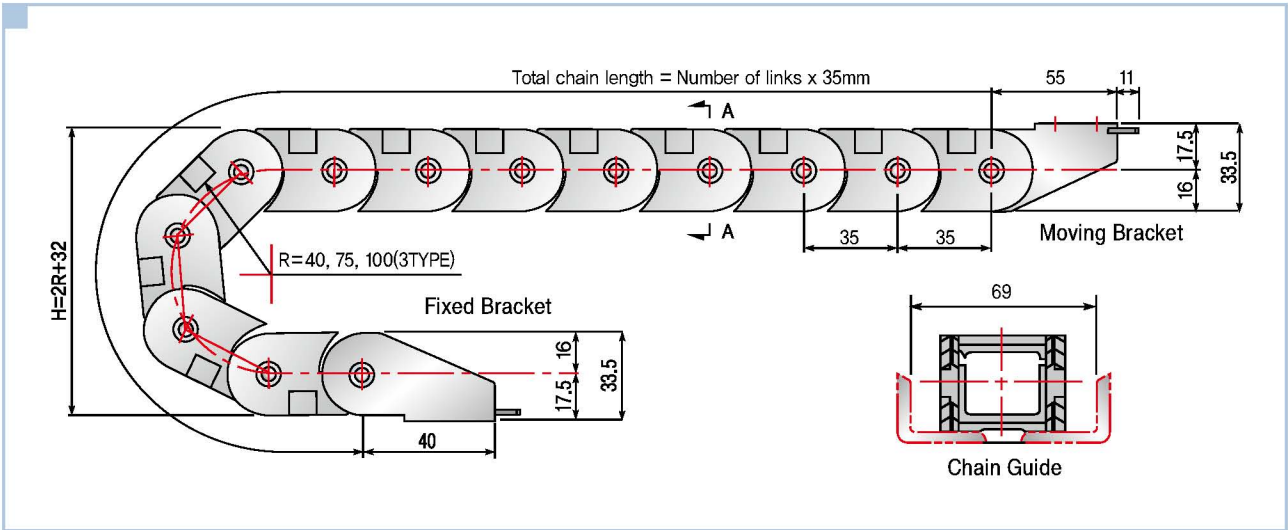

- Chain Length  $L = \frac{Ls}{2} + \pi R + 3P(2K)$
- 곡률반경에 따른 H값

R	40	75	100
H	112	182	232

⊕ A-A Cross Section / D.Max

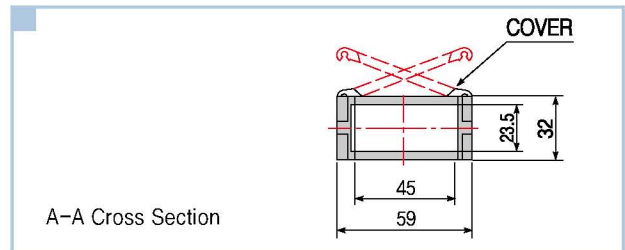
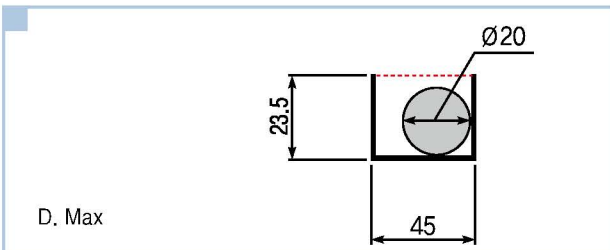

⊕ End Bracket

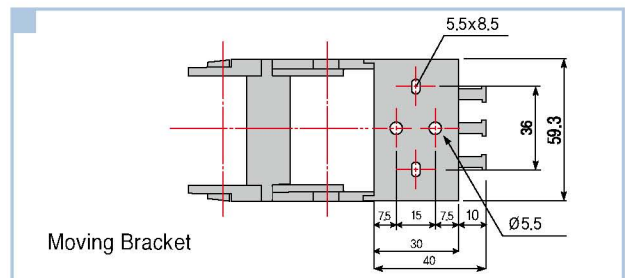
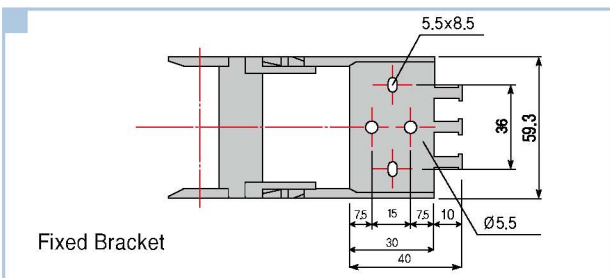

⊕ Order Example [ 주문예 ]

KJP 0350-2B / Type ➤ R75 / Radius ➤ 1000L / Length ➤ 3Sets / Q'ty

KJP TYPE

# KJP 0450-1B

KUKJE CABLECHAIN

⊕ Cablechain / Chain Pitch(P)=45mm

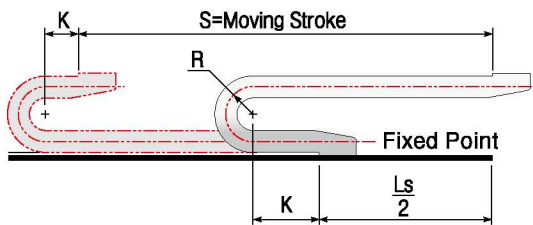
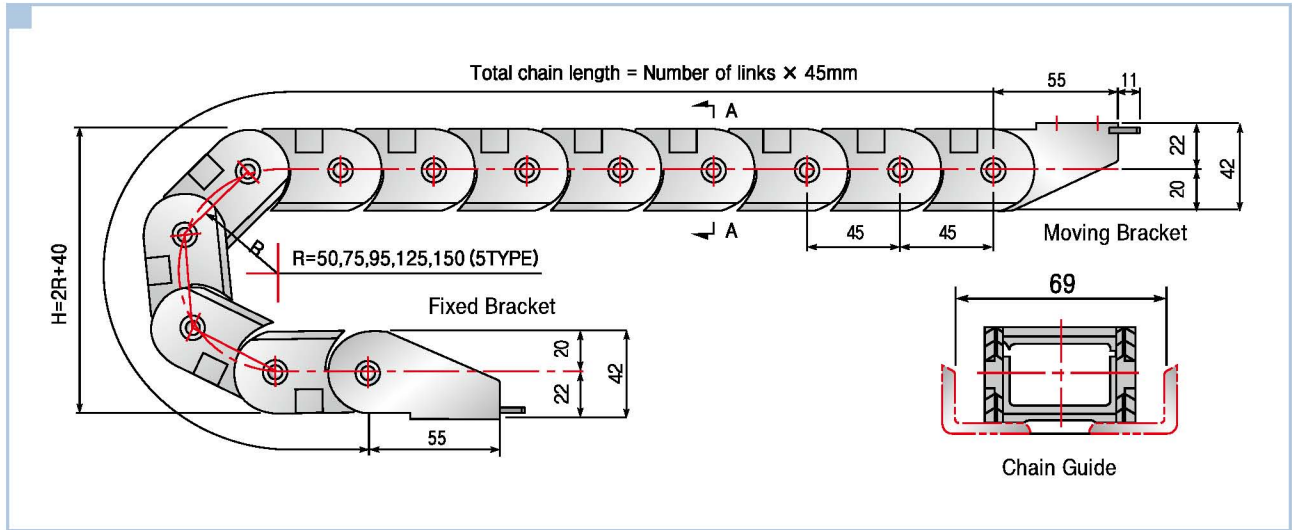

- Chain Length  $L = \frac{Ls}{2} + \pi R + 3P(2K)$
- 곡률반경에 따른 H값

R	50	75	95	125	150
H	140	190	230	290	340

⊕ A-A Cross Section / D.Max

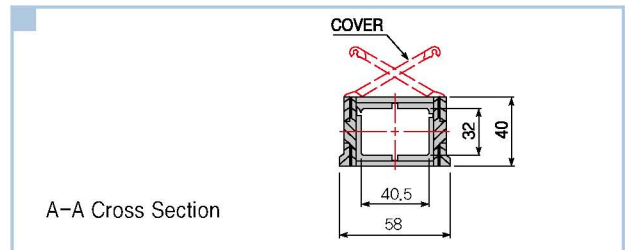
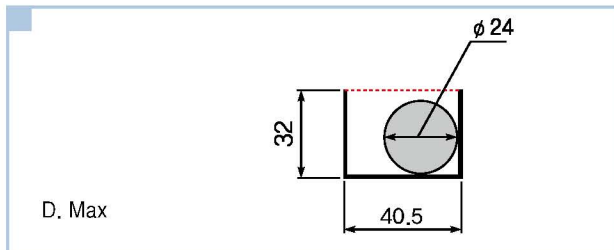

⊕ End Bracket

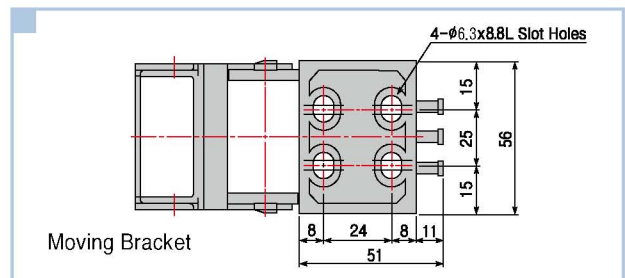
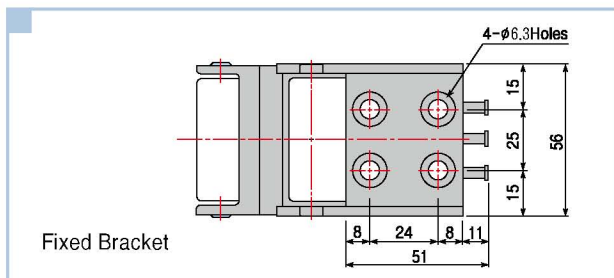

⊕ Order Example [ 주문예 ]

KJP 0450-1B / Type ➤ R50 / Radius ➤ 1350L / Length ➤ 20Sets / Q'ty



⊕ Cablechain / Chain Pitch(P)=45mm

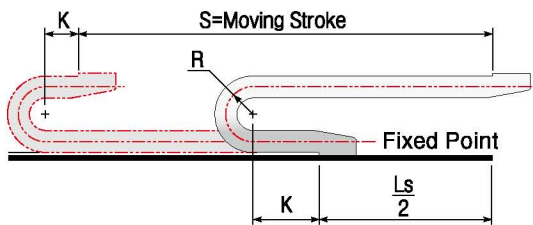
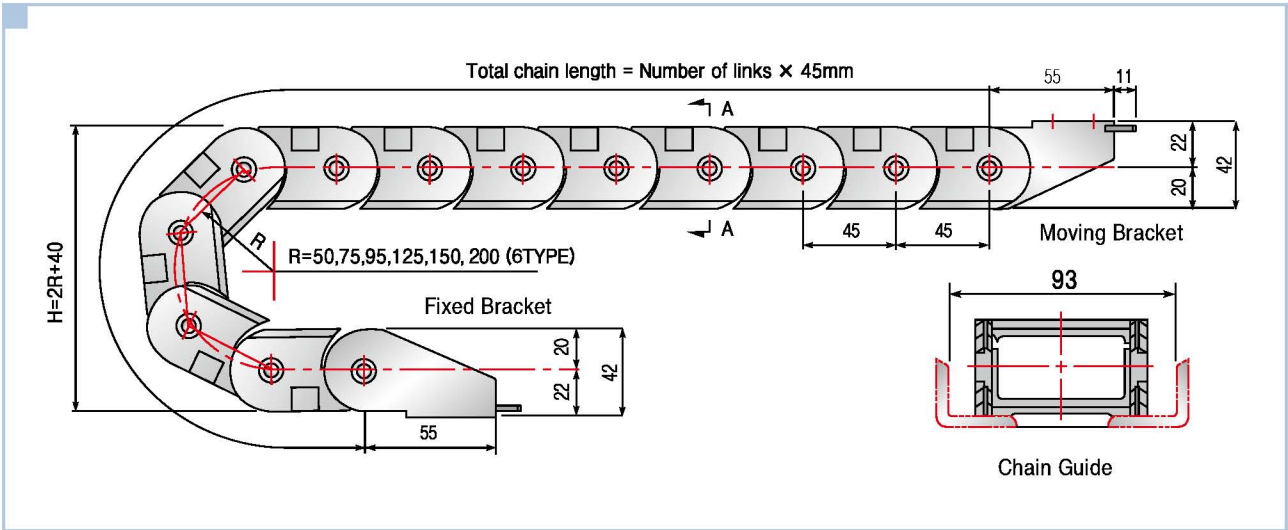

- Chain Length  $L = \frac{Ls}{2} + \pi R + 3P(2K)$
- 곡률반경에 따른 H값

R	50	75	95	125	150	200
H	140	190	230	290	340	440

⊕ A-A Cross Section / D.Max

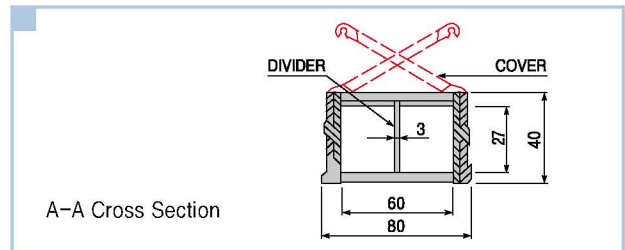
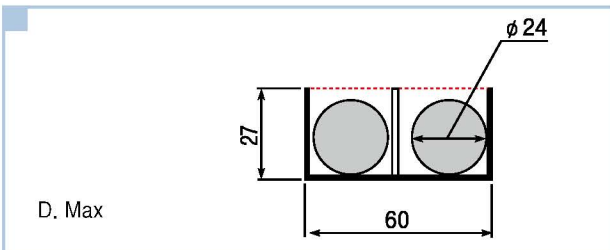

⊕ End Bracket

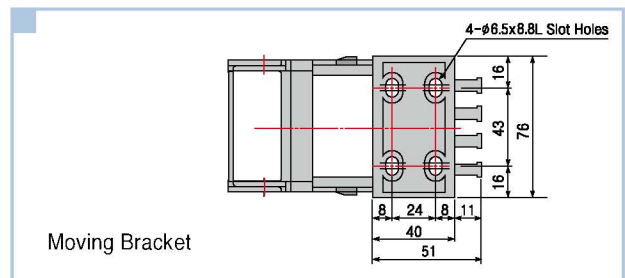
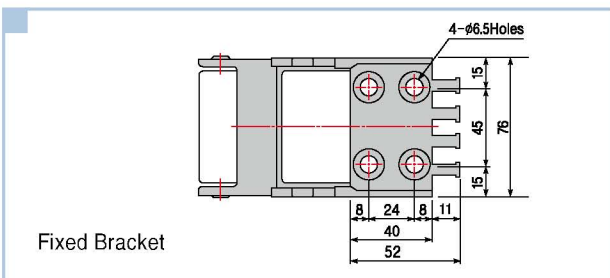

⊕ Order Example [ 주문예 ]

KJP 0450-2B / Type ➤ R95 / Radius ➤ 1350L / Length ➤ 5Sets / Q'ty

KJP TYPE

# KJP 0450-3B

KUKIJE CABLECHAIN

⊕ Cablechain / Chain Pitch(P)=45mm

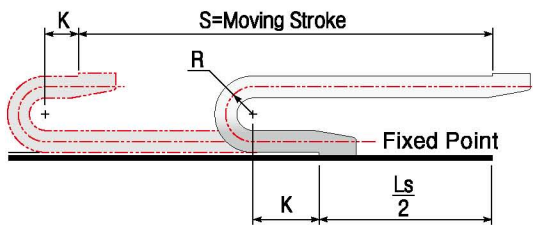
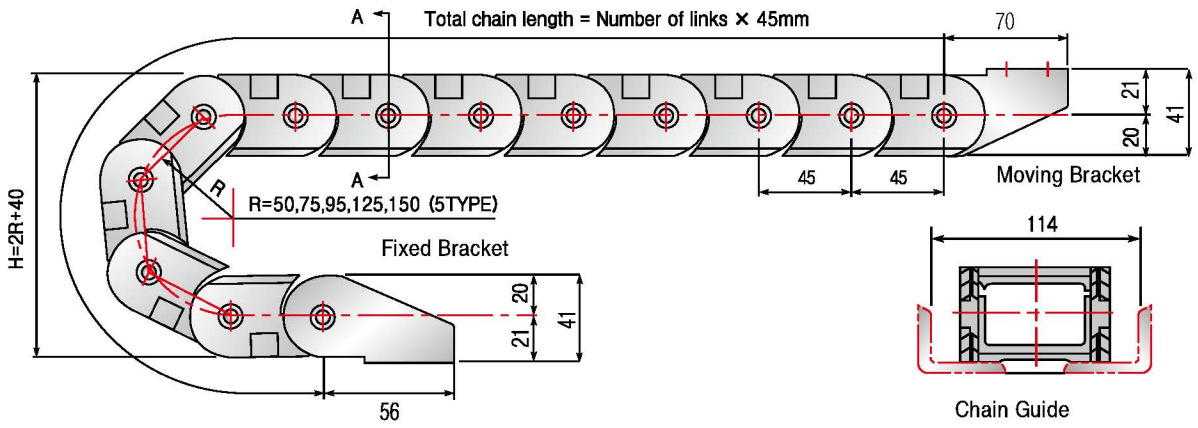

- Chain Length  $L = \frac{Ls}{2} + \pi R + 3P(2K)$
- 곡률반경에 따른 H값

R	50	75	95	125	150
H	140	190	230	290	340

⊕ A-A Cross Section / D.Max

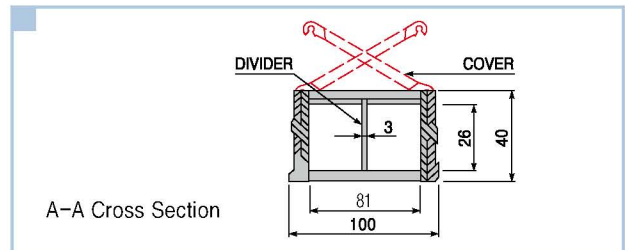
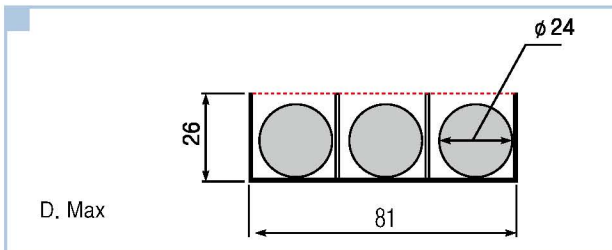

⊕ End Bracket

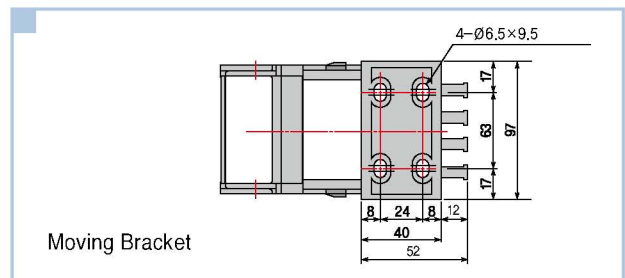
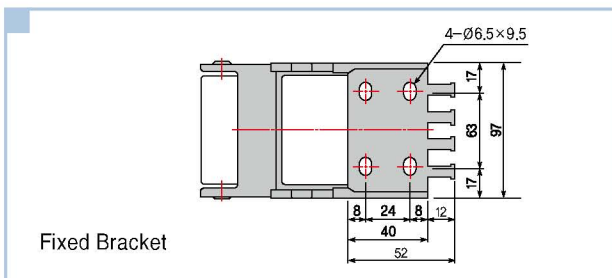

⊕ Order Example [ 주문예 ]

KJP 0450-3B / Type ➤ R95 / Radius ➤ 1350L / Length ➤ 20Sets / Q'ty

⊕ Cablechain / Chain Pitch(P)=45mm

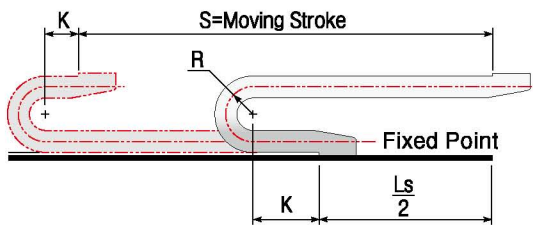
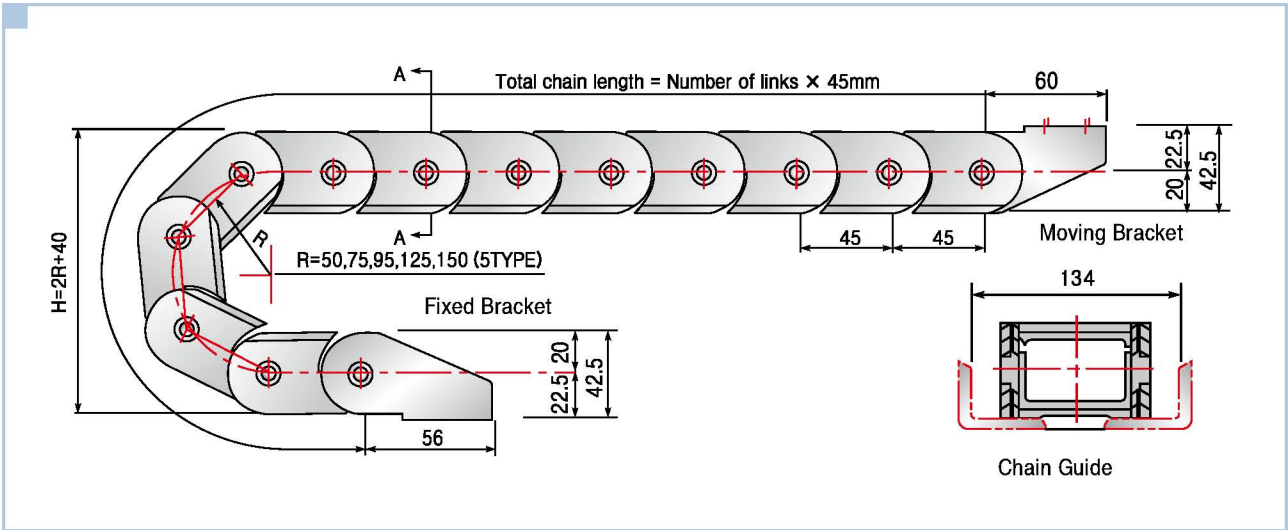

- Chain Length  $L = \frac{Ls}{2} + \pi R + 3P(2K)$
- 곡률반경에 따른 H값

R	50	75	95	125	150
H	140	190	230	290	340

⊕ A-A Cross Section / D.Max

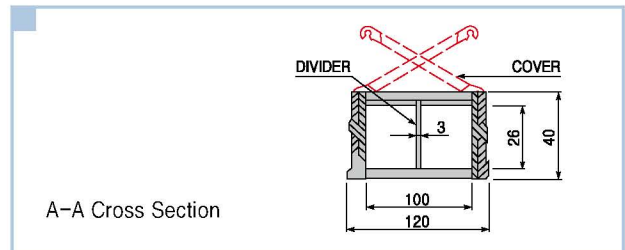
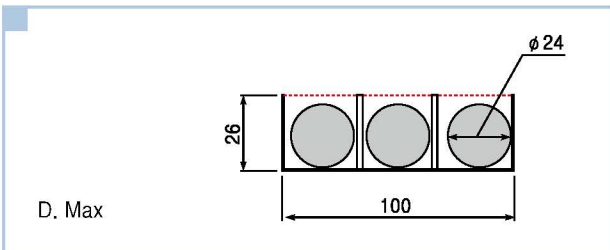

⊕ End Bracket

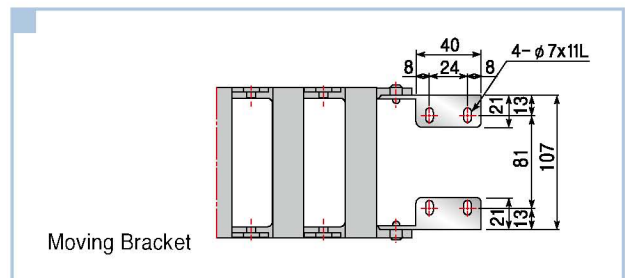
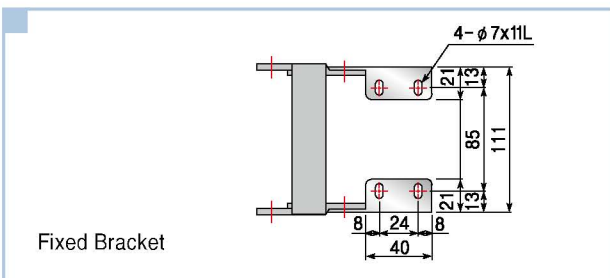

⊕ Order Example [ 주문예 ]

KJP 0450-4B / Type ➤ R95 / Radius ➤ 2000L / Length ➤ 5Sets / Q'ty

KJP TYPE

# KJP 0625-1B

KUKJE CABLECHAIN

KJP TYPE

## Cablechain / Chain Pitch(P)=62.5mm

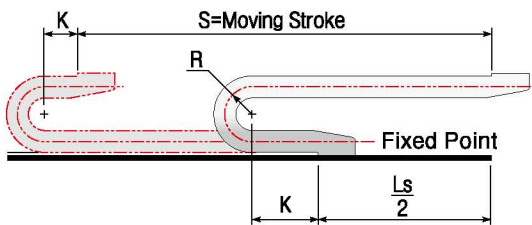
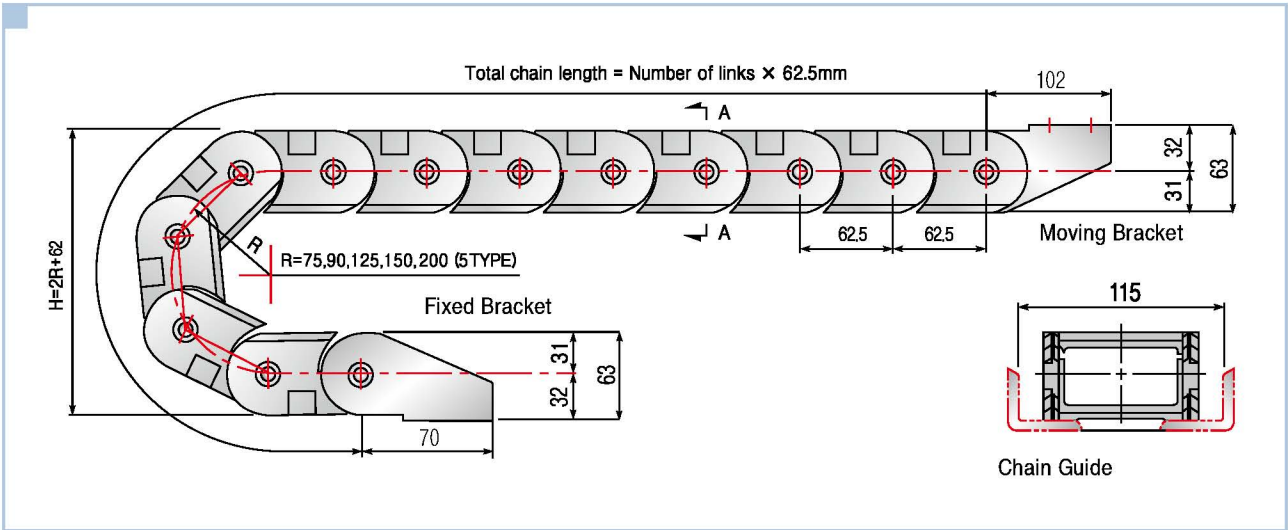

- Chain Length  $L = \frac{Ls}{2} + \pi R + 3P(2K)$
- 곡률반경에 따른 H값

R	75	90	125	150	200
H	212	242	312	362	462

## A-A Cross Section / D.Max

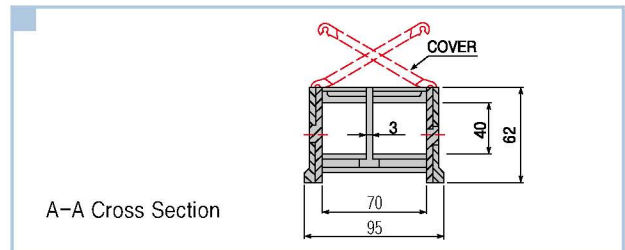
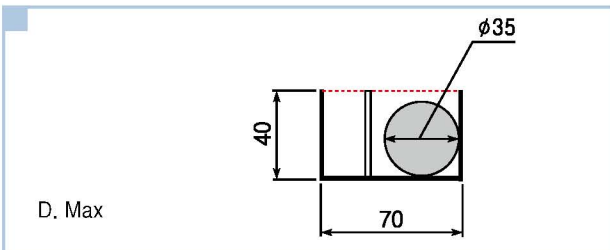

## End Bracket

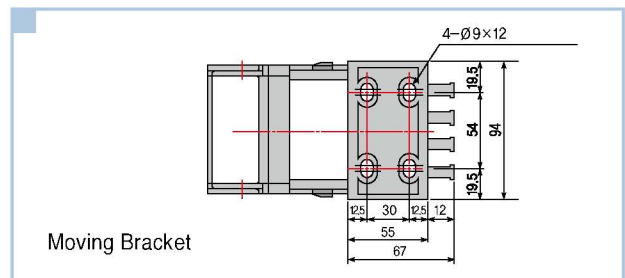
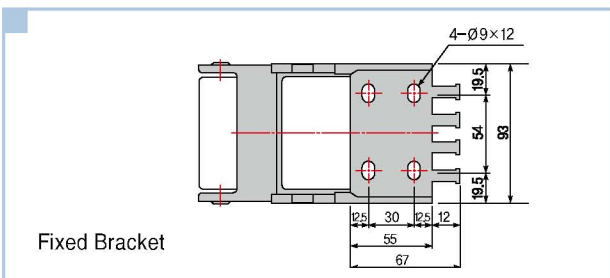

## Order Example [ 주문예 ]

KJP 0625-1B / Type ➤ R90 / Radius ➤ 1500L / Length ➤ 10Sets / Q'ty

⊕ Cablechain / Chain Pitch(P)=62.5mm

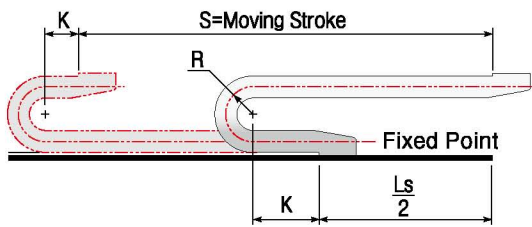
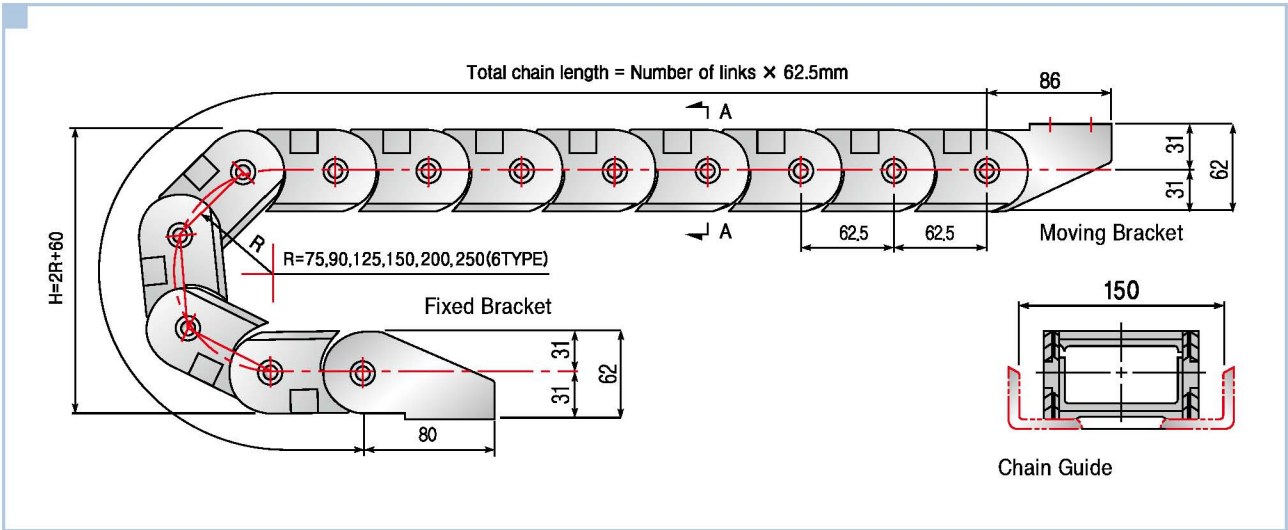

- Chain Length  $L = \frac{Ls}{2} + \pi R + 3P(2K)$
- 곡률반경에 따른 H값

R	75	90	125	150	200	250
H	210	240	310	360	460	560

⊕ A-A Cross Section / D.Max

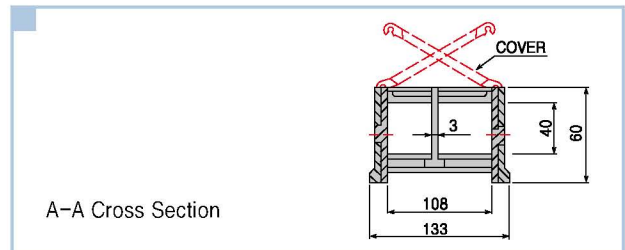
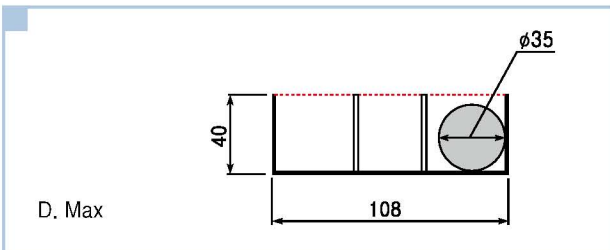

⊕ End Bracket

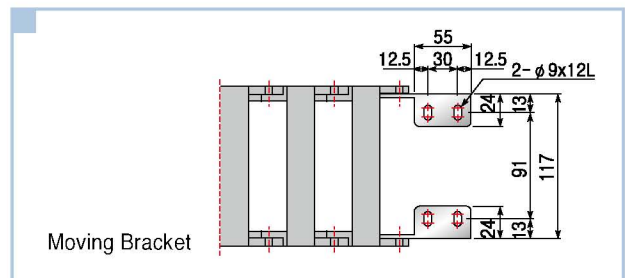
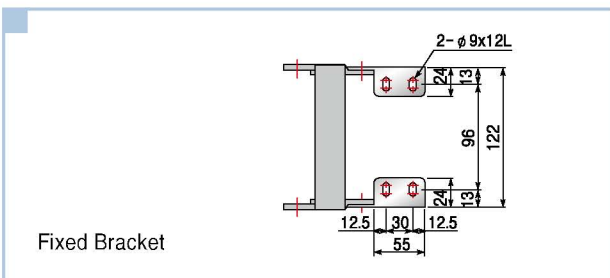

⊕ Order Example [ 주문예 ]

KJP 0625-2B / Type ➤ R125 / Radius ➤ 2000L / Length ➤ 5Sets / Q'ty

KJP TYPE

# KJP 0625-3B

KUKJE CABLECHAIN

KJP TYPE

## ⊕ Cablechain / Chain Pitch(P)=62.5mm

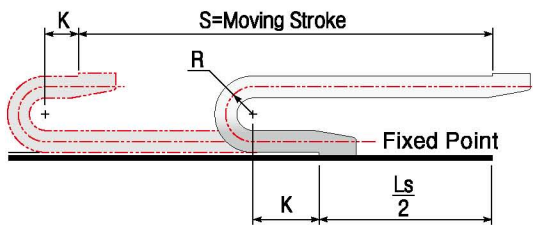
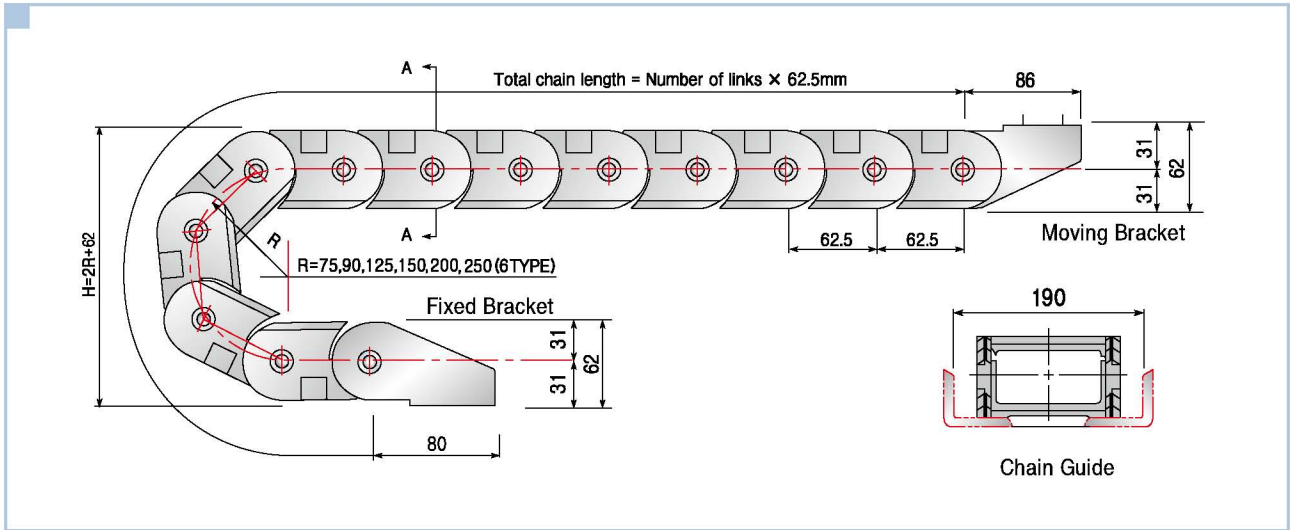

- Chain Length  $L = \frac{Ls}{2} + \pi R + 3P(2K)$
- 곡률반경에 따른 H값

R	75	90	125	150	200	250
H	212	242	312	362	462	562

## ⊕ A-A Cross Section / D.Max

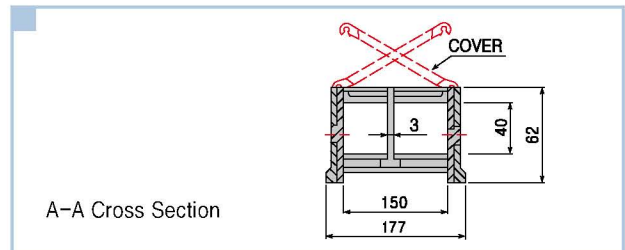
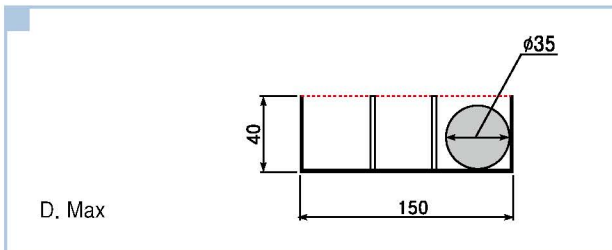

## ⊕ End Bracket

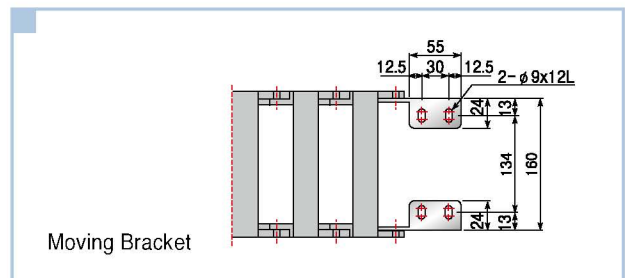
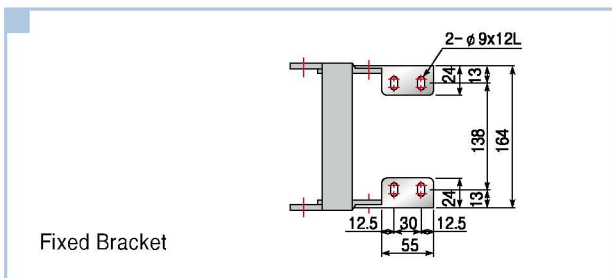

## ⊕ Order Example [ 주문예 ]

KJP 0625-3B / Type ➤ R125 / Radius ➤ 2000L / Length ➤ 10Sets / Q'ty