



독일 IPA 클린룸 사용인증 (CLASS2)

Overview of classification results

The following table gives an overview of the classification of each of the test pieces TP-1 to PT3:

TP01 : KJSC17-B20-R30				
Measuring Point	MP01	MP02	MP03	MP04
Parameter set 1				
Air Cleanliness Class (acc. to ISO 14644-1)	1	1	2	1
Parameter set 2				
Air Cleanliness Class (acc. to ISO 14644-1)	1	1	1	1
Parameter set 3				
Air Cleanliness Class (acc. to ISO 14644-1)	1	2	1	2
TP02 : KJSC24-B40-R50				
Measuring Point	MP05	MP06	MP07	MP08
Parameter set 1				
Air Cleanliness Class (acc. to ISO 14644-1)	2	2	1	7
Parameter set 2				
Air Cleanliness Class (acc. to ISO 14644-1)	6	5	1	7
Parameter set 3				
Air Cleanliness Class (acc. to ISO 14644-1)	6	6	2	7
TP03 : KJSC40-B50-R110				
Measuring Point	MP09	MP10	MP11	MP12
Parameter set 1				
Air Cleanliness Class (acc. to ISO 14644-1)	1	1	1	1
Parameter set 2				
Air Cleanliness Class (acc. to ISO 14644-1)	1	1	2	1
Parameter set 3				
Air Cleanliness Class (acc. to ISO 14644-1)	1	1	1	1

Overall classification of the test pieces TP01 to TP03



KJSC TYPE

CLEAN ROOM · 저소음 · 저분진

Link와 Link를 Band Pin으로 연결하는 구조로 되어있어 기장의 늘임과 줄임이 가능하고 고속주행에도 저소음 저분진을 유지하여 주어 반도체 생산설비, Display 장비 등 Clean Room 환경의 최적의 제품입니다.

CLEAN ROOM

LINKS ARE CONNECTED BY BAND PIN SO THE LENGTH CAN BE LENGTHENED AND SHORTENED WHILE HIGH-SPEED TRAVELING, IT KEEPS LOW NOISE AND LOW DUST. IT IS AN OPTIMUM PRODUCT FOR CLEANROOM ENVIRONMENT SUCH AS SEMICONDUCTOR PRODUCTION FACILITIES, DISPLAY EQUIPMENT.

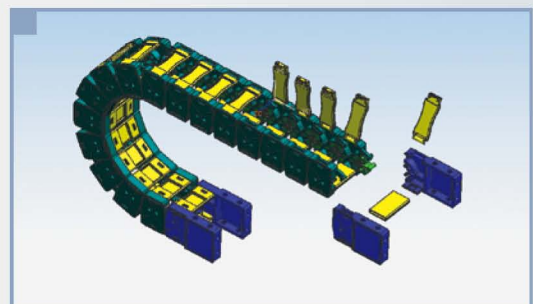

KJSC 17 TYPE

⊕ Cablechain / Chain Pitch(P)=17mm

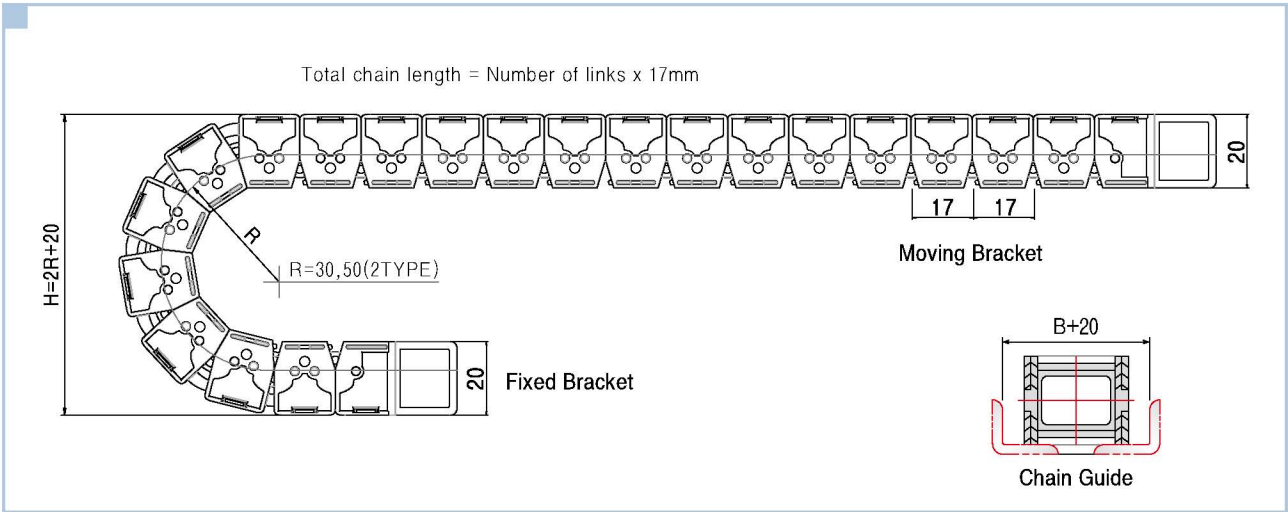

⊕ A-A Cross Section / D.Max

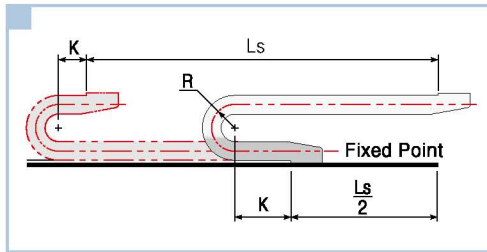
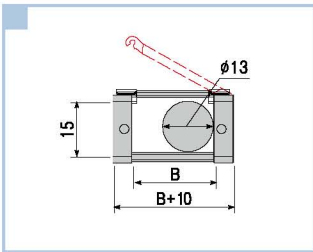

- Chain Length $L = \frac{L_s}{2} + \pi R + 90$
- 곡률반경에 따른 H값

R	30	50
H	80	120

⊕ B 20

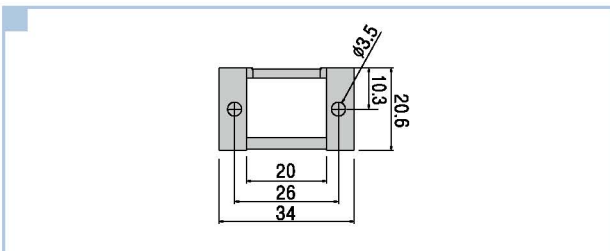

⊕ B 40

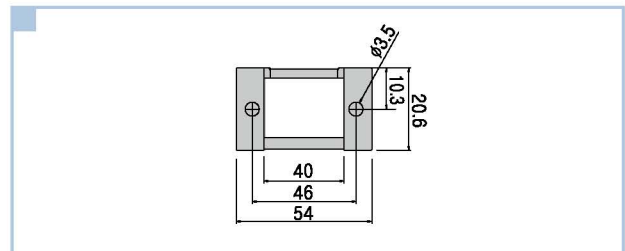

⊕ End Bracket

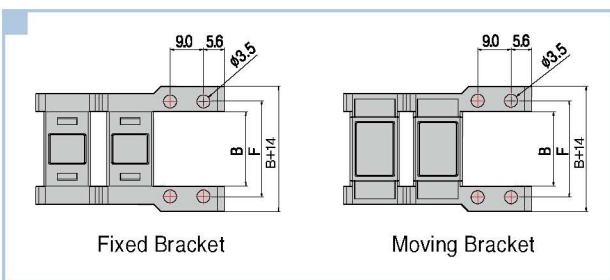

단위 mm

SERIES WITH RODS	F(B+6)
KJSC 17-B20	26
KJSC 17-B40	46

⊕ Order Example [주문예]

KJSC 17-B20 / Type ➤ R30 / Radius ➤ 30L/K / Length ➤ 3Sets / Q'ty

⊕ Cablechain / Chain Pitch(P)=24mm

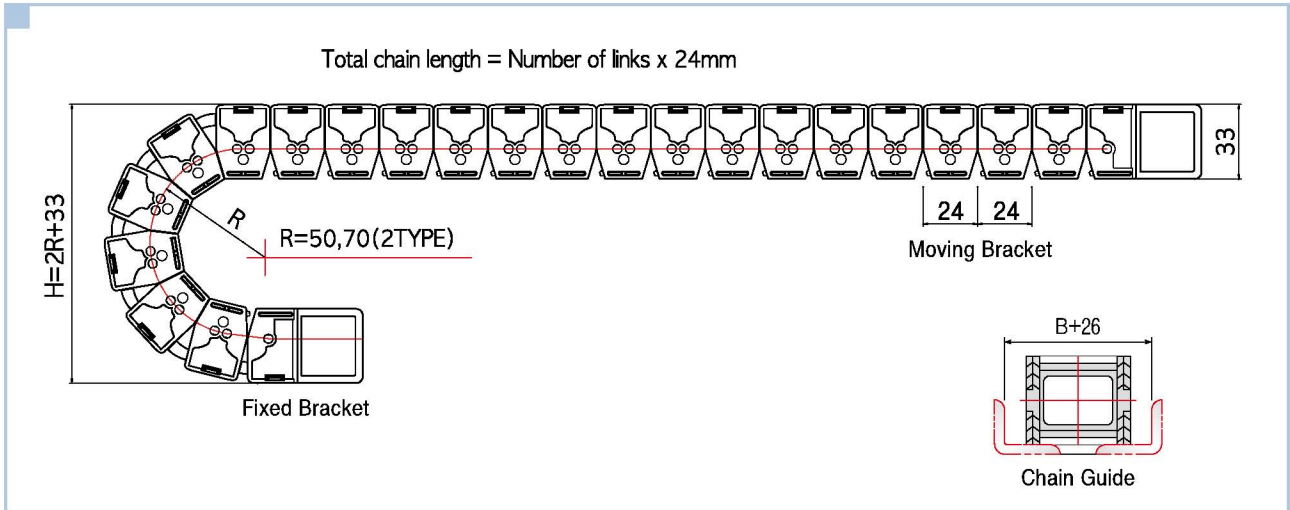

⊕ A-A Cross Section / D.Max

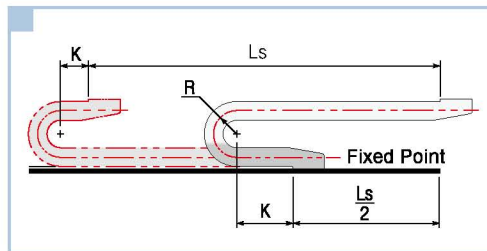
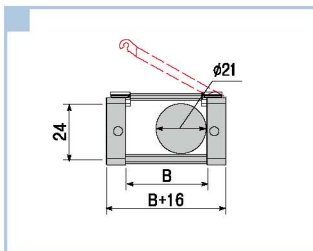

- Chain Length $L = \frac{Ls}{2} + \pi R + 130$
- 곡률반경에 따른 H값

R	50	70
H	133	173

⊕ B 40

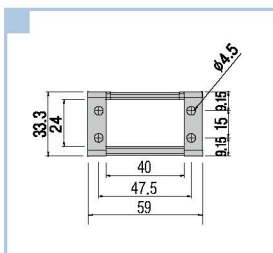

⊕ B 55

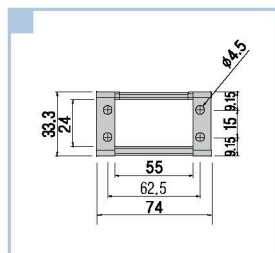

⊕ B 80

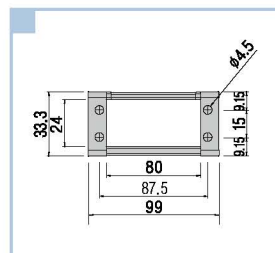

⊕ B 110

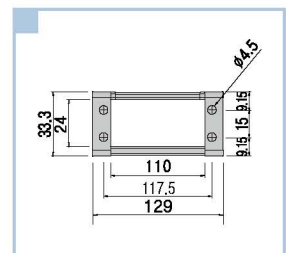

⊕ End Bracket

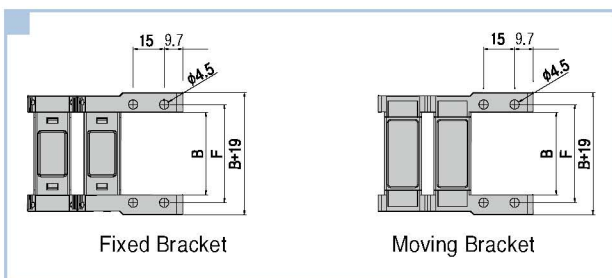

단위 mm

SERIES WITH RODS	F(B+7.5)
KJSC 24-B40	47.5
KJSC 24-B55	62.5
KJSC 24-B80	87.5
KJSC 24-B110	117.5

⊕ Order Example [주문예]

KJSC 24-B40 / Type ➤ R50 / Radius ➤ 45L/K / Length ➤ 5Sets / Q'ty

KJSC 32 TYPE

⊕ Cablechain / Chain Pitch(P)=32mm

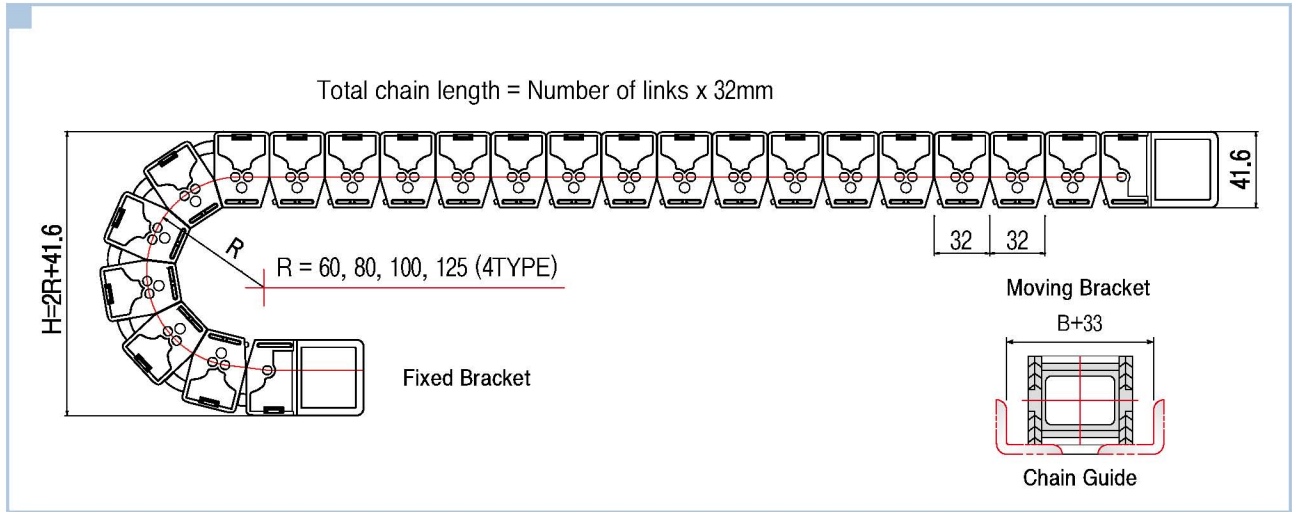

⊕ A-A Cross Section / D.Max

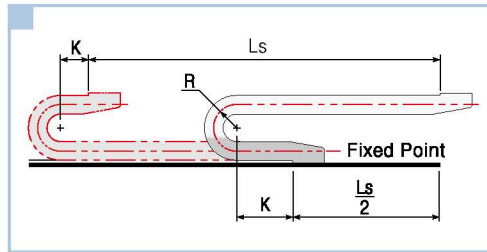
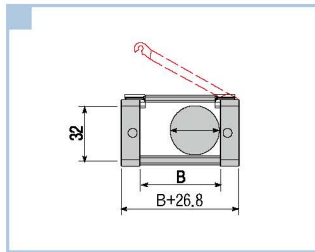

- Chain Length $L = \frac{Ls}{2} + \pi R + 160$
- 곡률반경에 따른 H값

R	60	80	100	125
H	161.6	201.6	241.6	291.6

⊕ B 35

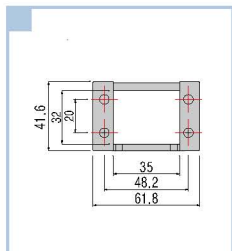

⊕ B 55

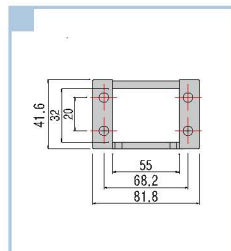

⊕ B 75

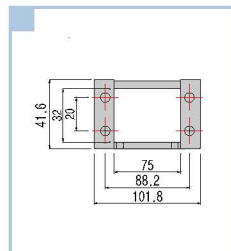

⊕ B 100

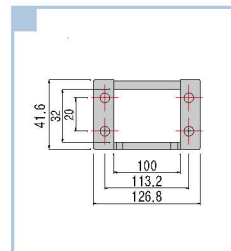

⊕ B 125

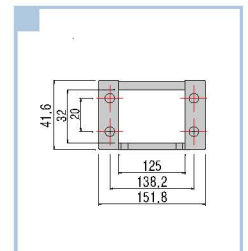

⊕ End Bracket

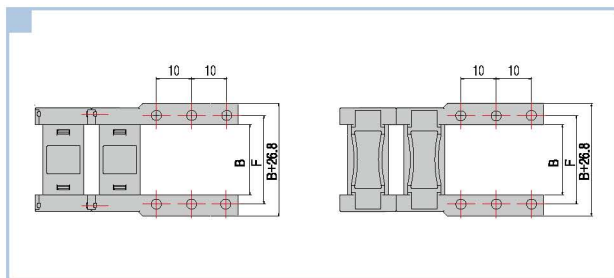

단위 mm

SERIES WITH RODS	F(B+13.2)
KJSC 32-B35	48.2
KJSC 32-B55	68.2
KJSC 32-B75	88.2
KJSC 32-B100	113.2
KJSC 32-B125	138.2

⊕ Order Example [주문예]

KJSC 32-B75 / Type ➤ R100 / Radius ➤ 45L/K / Length ➤ 5Sets / Q'ty

⊕ Cablechain / Chain Pitch(P)=40mm

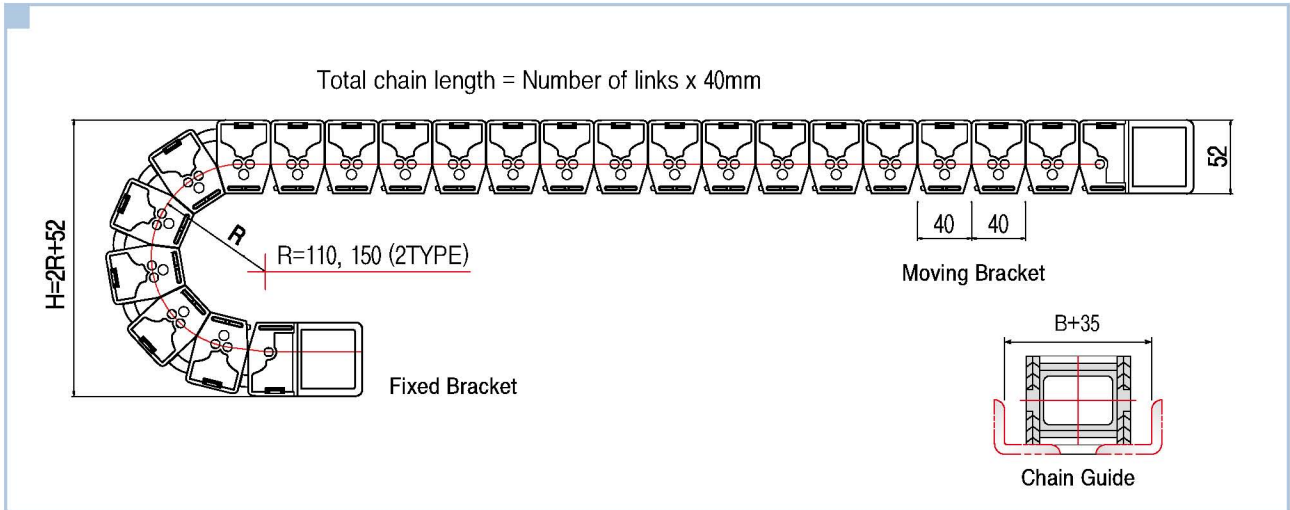

⊕ A-A Cross Section / D.Max

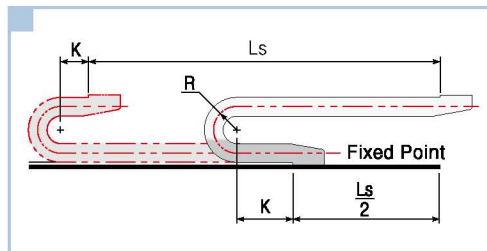
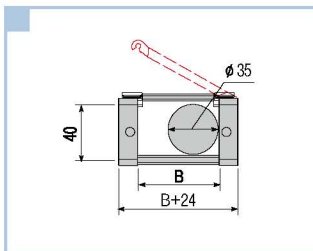

- Chain Length $L = \frac{Ls}{2} + \pi R + 250$
- 곡률반경에 따른 H값

R	110	150
H	272	352

⊕ B 50

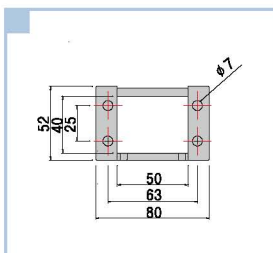

⊕ B 70

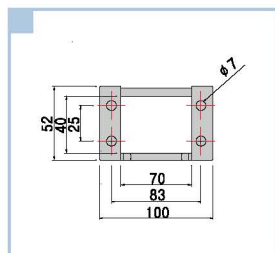

⊕ B 100

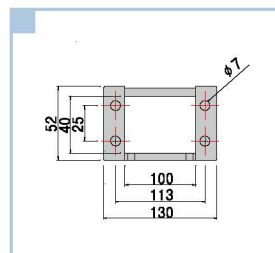

⊕ B 150

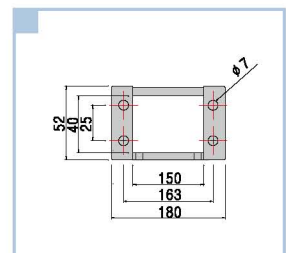

⊕ End Bracket

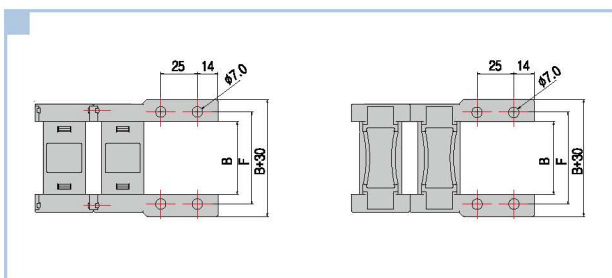

단위 mm

SERIES WITH RODS	F(B+13)
KJSC 40-B50	63
KJSC 40-B70	83
KJSC 40-B100	113
KJSC 40-B150	163

⊕ Order Example [주문예]

KJSC 40-B70 / Type ➤ R110 / Radius ➤ 70L/K / Length ➤ 5Sets / Q'ty

KJSC 60 TYPE

⊕ Cablechain / Chain Pitch(P)=60mm

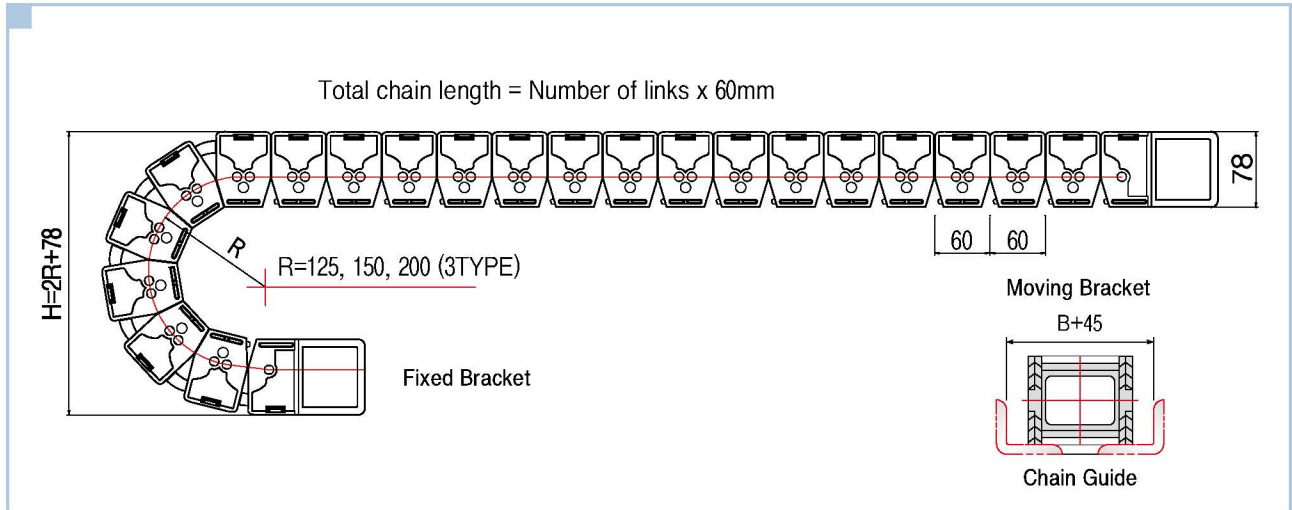

⊕ A-A Cross Section / D.Max

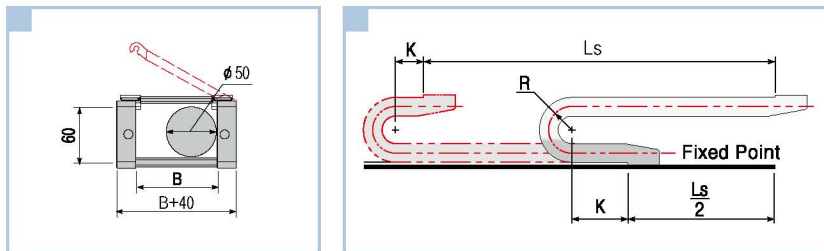

- Chain Length $L = \frac{Ls}{2} + \pi R + 380$
- 곡률반경에 따른 H값

R	125	150	175	200
H	328	378	428	478

⊕ B 100

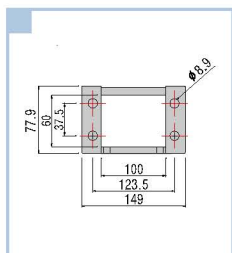

⊕ B 125

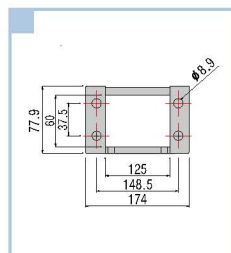

⊕ B 150

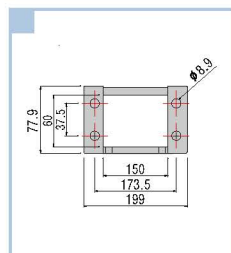

⊕ B 175

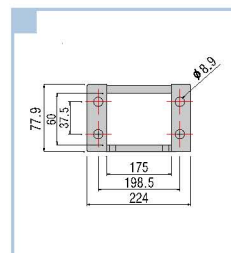

⊕ B 200

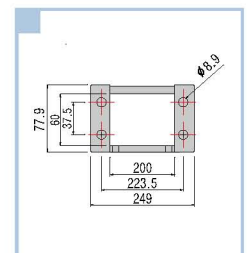

⊕ End Bracket

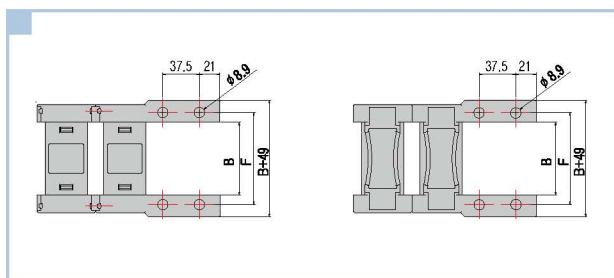

단위 mm

SERIES WITH RODS	F(B+23.5)
KJSC 60-B100	123.5
KJSC 60-B125	148.5
KJSC 60-B150	173.5
KJSC 60-B175	198.5
KJSC 60-B200	223.5

⊕ Order Example [주문예]

KJSC 60-B100 / Type ➤ R125 / Radius ➤ 70L/K / Length ➤ 5Sets / Q'ty